

STATE OF IOWA
 STATE HIGHWAY COMMISSION
 DESIGN FOR
 TWO 30'X20' CONCRETE SLAB BRIDGES
 ONE 42'-6"X20' PRE-STRESSED CONCRETE BEAM BRIDGE
 SECONDARY ROAD SYSTEM
 CRAWFORD COUNTY
 JANUARY, 1962
 PROJ. 62-32

SPECIFICATIONS:
 DESIGN: A.A.S.H.O. SERIES OF 1957.
 CONSTRUCTION: STANDARD SPECIFICATIONS
 OF THE IOWA STATE HIGHWAY COMMISSION,
 SERIES OF 1960, PLUS CURRENT SPECIAL
 PROVISIONS EXCEPT AS NOTED.

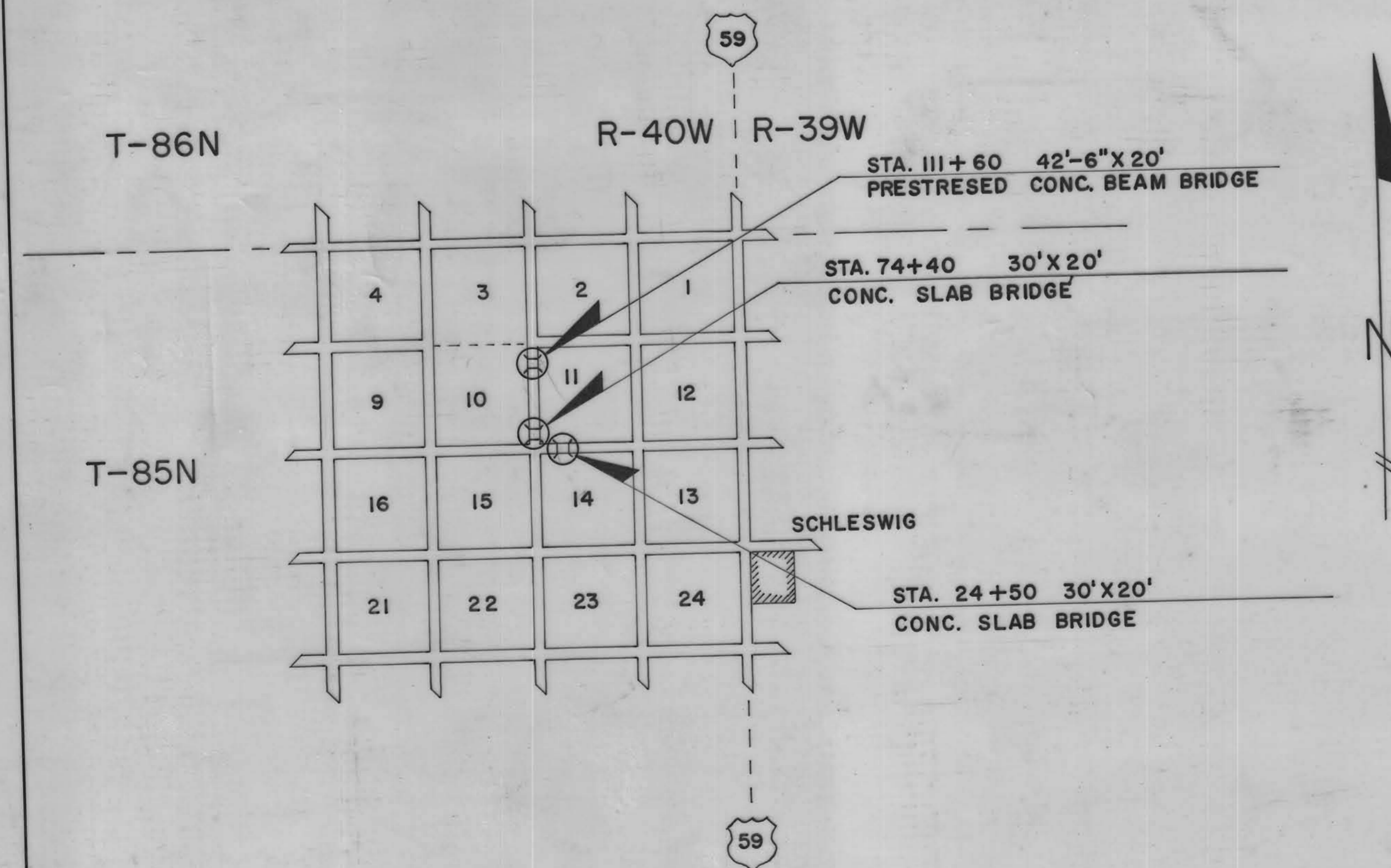

| | |
|-------------------|------|
| APPROVED | DATE |
| CHAIRMAN | |
| APPROVED | |
| DISTRICT ENGINEER | DATE |
| APPROVED | |
| COUNTY ENGINEER | DATE |

MORGAN TOWNSHIP
T-85N R-40W
BET. SEC. 11 & 14

| ESTIMATE OF QUANTITIES | | | |
|---|---------------|----------------|----------------|
| DESCRIPTION | ABUTMENTS | SUPERSTRUC. | TOTALS |
| STRUCTURAL CONCRETE | 5.60 CU. YDS. | 46.20 CU. YDS. | 51.80 CU. YDS. |
| REINFORCING STEEL | 587 LBS. | 8028 LBS. | 8615 LBS. |
| CREOSOTED LUMBER | 6816 FBM | | 6816 FBM |
| STRUCTURAL STEEL | 4585 LBS. | 1541 LBS. | 6126 LBS. |
| GALVANIZED HARDWARE | 145 LBS. | | 145 LBS. |
| TREATED TRESTLE PILING 12@45', 8@40', 4@35', 4@30' | | | 1120 L.F. |
| EXCAV. CLASS 10 CHANNEL | | | |
| EXCAV. CLASS 20 | 278 CU. YDS. | | 278 CU. YDS. |
| EXCAV. CLASS 21 | 32 CU. YDS. | | 32 CU. YDS. |
| REMOVAL OF OLD BRIDGE | | | LUMP SUM |

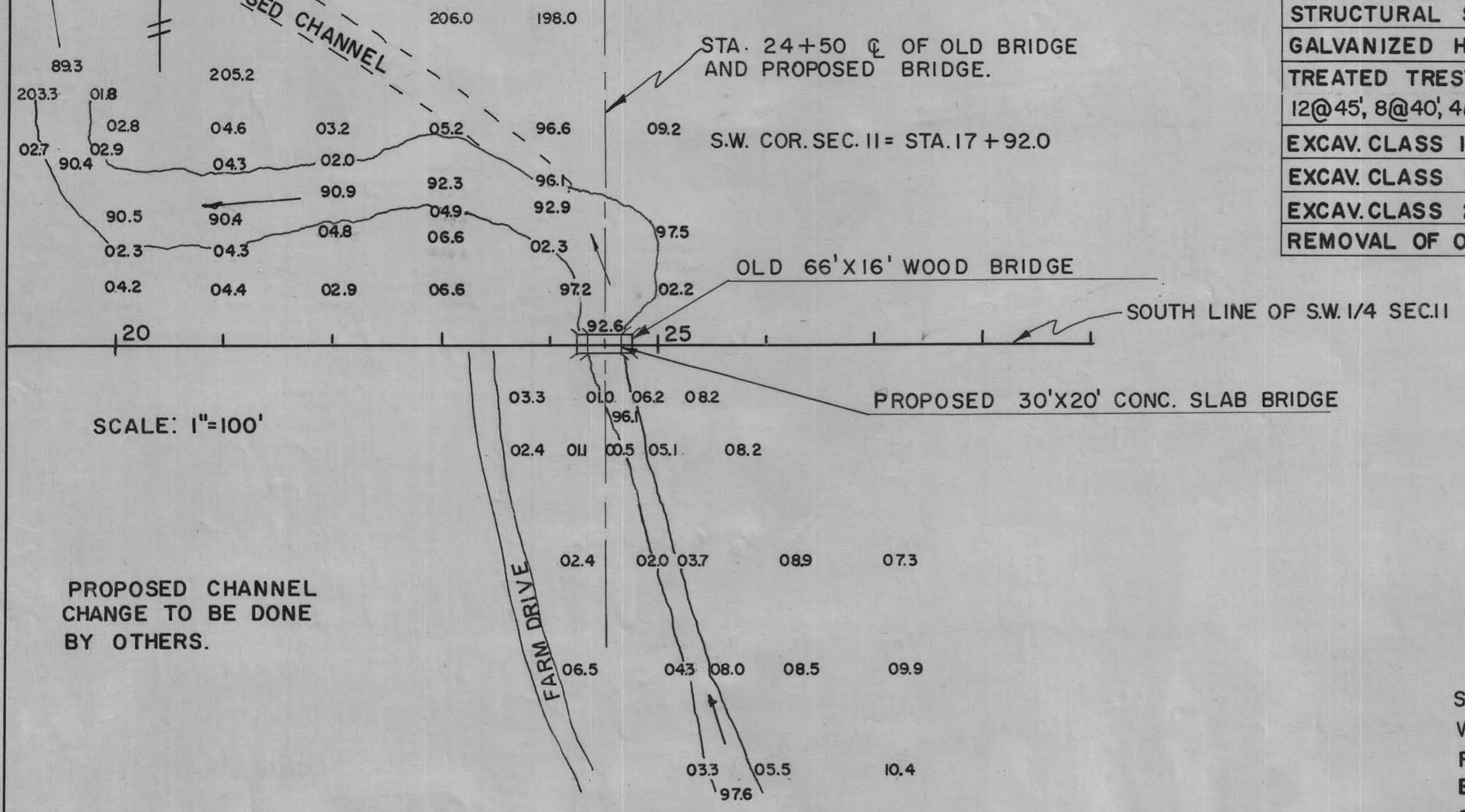

STA. 24+50 @ 34'X16' PRESENT WOOD BRIDGE WITH TWO 16' WOOD APPROACHS. DA=2600AC. REPLACE WITH 30'X20' CONCRETE SLAB BRIDGE. BRIDGE CONTRACTOR TO REMOVE OLD BRIDGE AND PILE WITHIN 300' OF BRIDGE SITE AS DIRECTED BY COUNTY ENGINEER.

GENERAL NOTES:
IOWA HIGHWAY COMMISSION STANDARD DESIGN J3A, H=20, MARCH, 1960, REVISED I-4-61, SHALL APPLY TO THIS BRIDGE.
ALL EXPOSED CORNERS OF 90° OR SHARPER ARE TO BE FILLETED 3/4".
ALL REINFORCING BARS ARE TO BE SECURELY WIRED IN PLACE AND ADEQUATELY SUPPORTED ON BAR CHAIRS BEFORE CONCRETE IS PLACED.
ALL CONSTRUCTION TO BE IN ACCORDANCE WITH THE IOWA HIGHWAY COMMISSION STANDARD SPECIFICATIONS, SERIES OF 1960, WITH CURRENT SPECIAL PROVISIONS APPLICABLE.

BRIDGE SIGN ASSEMBLY NOTE:
PLACE TRIPLE THREE-INCH RED REFLECTORS (M-200) AT EACH END OF THE BRIDGE ON BOTH SIDES FOR APPROACHING TRAFFIC. BY COUNTY.

LOCATION:
SEC. 11-14 MORGAN TOWNSHIP
T-85N R-40W
OVER BEAVER CREEK

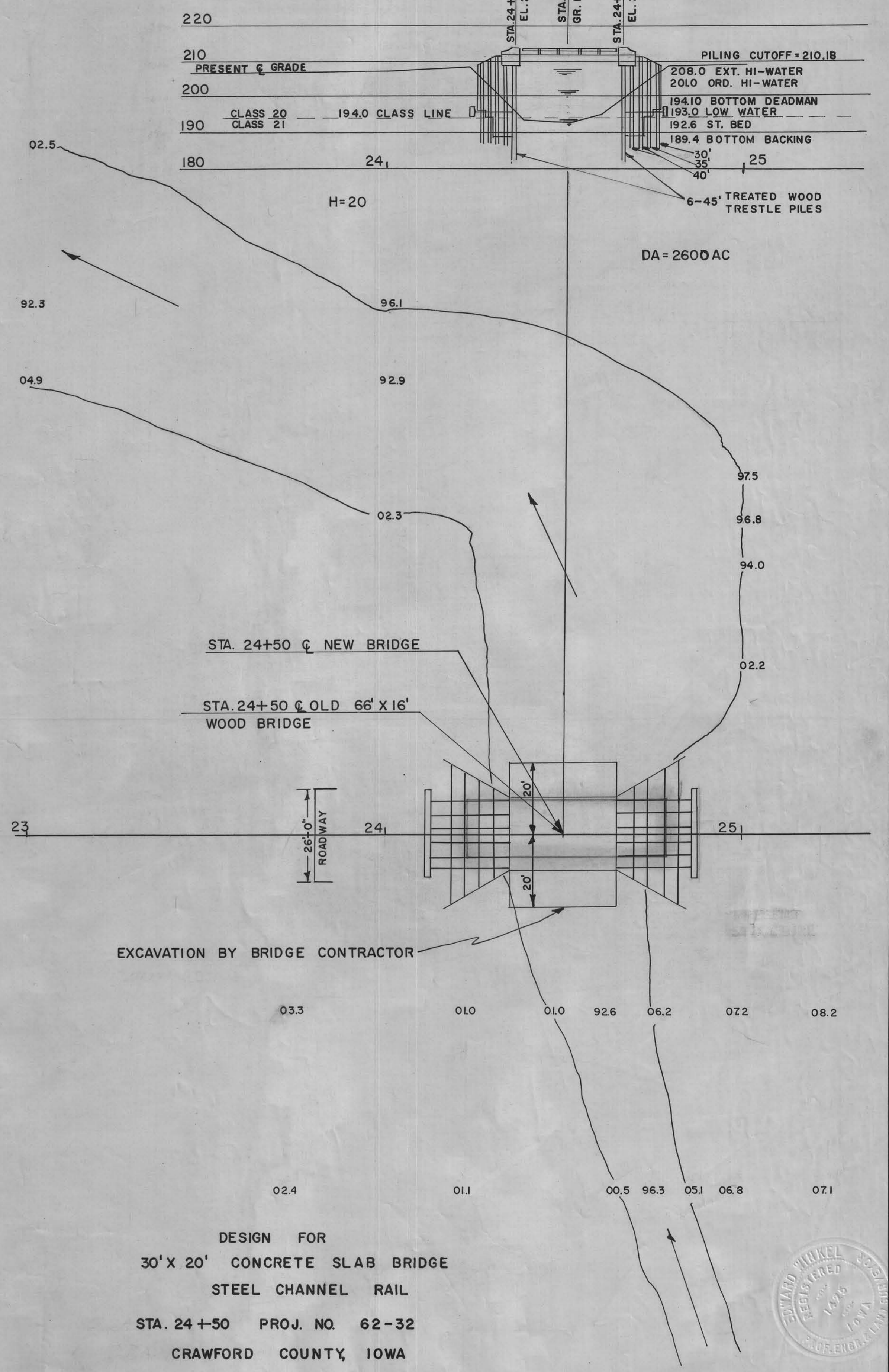

DESIGN FOR
30'X20' CONCRETE SLAB BRIDGE
STEEL CHANNEL RAIL
STA. 24+50 PROJ. NO. 62-32
CRAWFORD COUNTY, IOWA

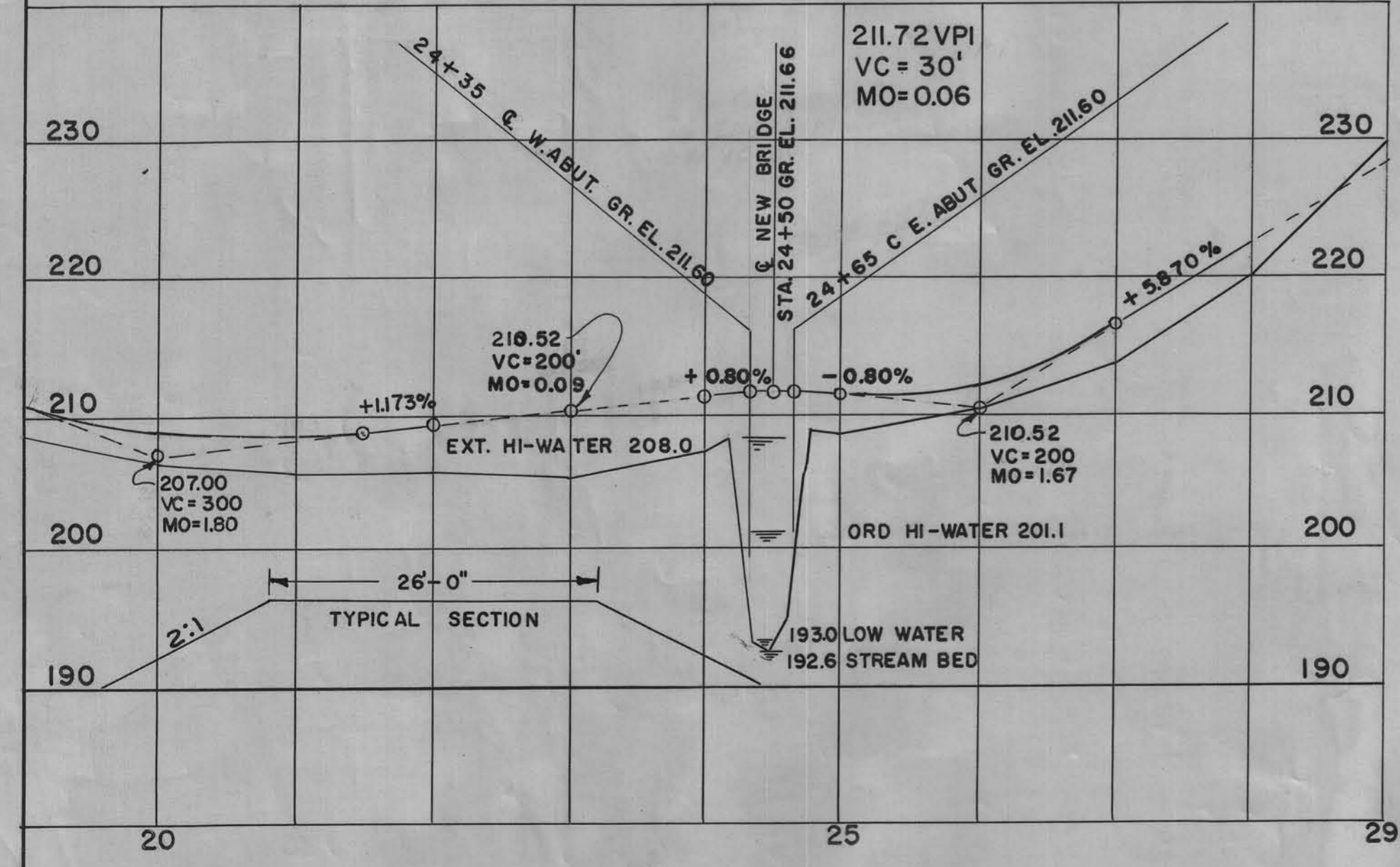

130640
10-11-14 Weyen
3-BRIDGES
10-11-14