

FILED DENISON, IOWA
CRAWFORD COUNTY

INDEXED
FOLLOW UP *mg*
PROBUD

2002 AU 19 AM 10: 28

INST. NO. *2002-2735*
DENISE MEEVES, RECORDER
Denise Meeves
FEE \$6.00

PREPARED BY: JAMES L. PETTY, P.L.S. 102 3RD STREET, PACIFIC JCT. IOWA 51561

UNITED STATES PUBLIC LAND SURVEY CORNER CERTIFICATE

OF
Land Survey Monument Situated in Section 31
Township 82 North, Range 41 West of the 5th Principal Meridian,
Crawford County, Iowa

Reason for preparing certificate, monumentation, found or placed, and procedure used in establishing corner position:

N $\frac{1}{4}$ CORNER SEC. 31-82-41, DUG AND FOUND NOTHING, SET 5/8" REBAR WITH YELLOW CAP PLS 11423 554.0 FEET WEST OF THE NORTHWEST CORNER OF HOUSE AS PER 1942 SURVEY NOTES.

NO CERTIFICATE OF RECORD

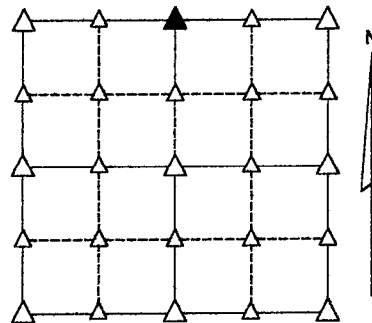

Sketch showing relative location of monument and accessories.

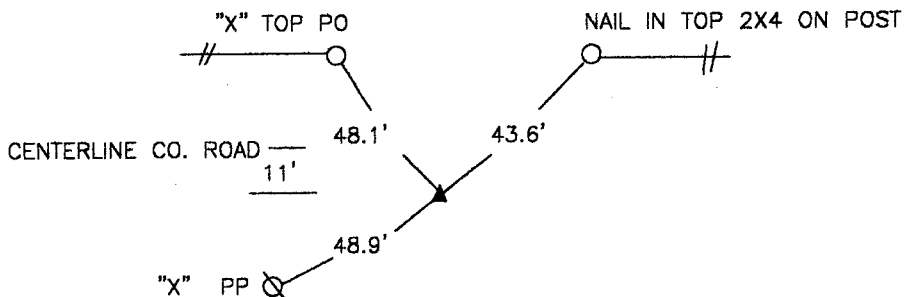

Note: All reference ties are to "X" nails unless noted otherwise

I HEREBY CERTIFY THAT THIS LAND SURVEYING DOCUMENT WAS PREPARED AND THE RELATED SURVEY WORK WAS PERFORMED BY ME OR UNDER MY DIRECT PERSONAL SUPERVISION AND THAT I AM A DULY LICENSED LAND SURVEYOR UNDER THE LAWS OF THE STATE OF IOWA.

James L. Petty *Aug 8, 2002*

JAMES L. PETTY, P.L.S. REG. NO. 11423 DATE:
MY license renewal date is DECEMBER 31, 2002.

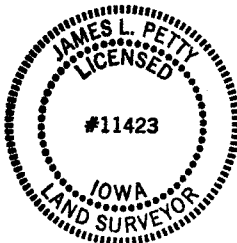

RECORDING OFFICER:
Corners to be indexed
Corner Section Twp Range