

Crawford County Recorder
 Denise Meeves
Fee Book 2013-0798
 04/05/2013 @10:54AM
 PLC PLAT CORNER CER
 Book: Page: # Pages: 1
 Total Fees: \$7.00

WILKE LAND SURVEYING INC. 401 1800th Street Panama, Iowa 51562 (712)499-2888

UNITED STATES PUBLIC LAND SURVEY CORNER CERTIFICATE

SECTION 36 TOWNSHIP 82N RANGE 41W COUNTY CRAWFORD

Monument Description and Remarks: Reason for Certificate: (No record Certificate)

NE CORNER - Found 5/8" dia. by 24" rebar with orange cap PLS #17048, 0.50' deep in the bottom of the East road ditch. Corner is in line with fence to the East.

NE CORNER NW1/4 NW1/4 - Set 5/8" dia. by 24" rebar with orange cap PLS #17048, 0.30' deep in line with fences North, East, & West. Corner is 0.60' Southwest of "X" nails in Southwest face of corner post with fences running North, West, and East.

NW CORNER - Dug with backhoe and found broken concrete monument laying sideways from previous dirt work. Set 5/8" dia. by 24" rebar with orange cap PLS #17048 0.70' deep. Corner is on line with the West line of the SW1/4 NW1/4 projected North, and in line with fence to the West. Fits good with WPA chaining distance (15.8') to corner post West.

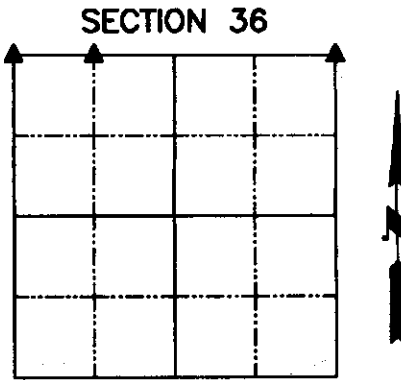

NW CORNER
 SEC. 36, T82N, R41W
 (Set 5/8" dia. by 24" rebar
 w/orange cap PLS #17048, 0.7' deep)

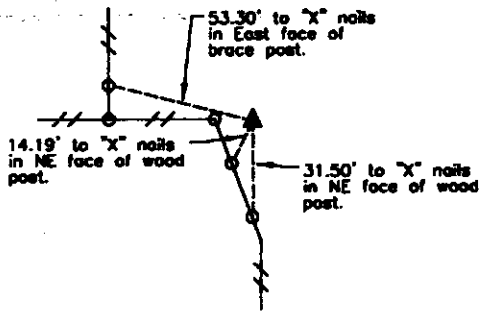

NE CORNER
 SEC. 36, T82N, R41W
 (Fnd. 5/8" dia. by 24" rebar
 w/orange cap PLS #17048, 0.5'
 deep in bottom of road ditch)

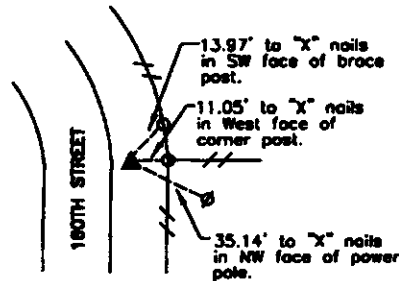

NE CORNER
 NW1/4 NW1/4
 SEC. 36, T82N, R41W
 (Set 5/8" dia. by 24" rebar
 w/orange cap PLS #17048, 0.3' deep)

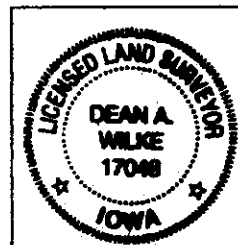
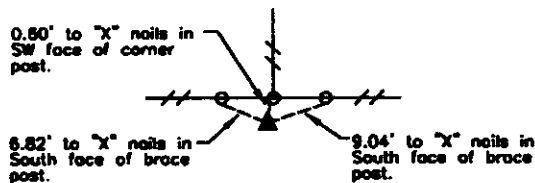

List Corners to be Indexed			
Corner	Section	Twp.	Range
NE CORNER	36	82N	41W
NE CORNER NW1/4 NW1/4	36	82N	41W
NW CORNER	36	82N	41W

I hereby certify that this land surveying document was prepared and the related survey work was performed by me or under my direct personal supervision and that I am a duly Licensed Land Surveyor under the laws of the State of Iowa.

Dean A. Wilke 4/03/13
 Dean A. Wilke Date

License number 17048

My license renewal date is December 31, 2013

Pages or sheets covered by this seal: This page only