

INDEXED ms 29  
FOLLOW UP RM  
PROCESSED  
SCANNED km

Crawford County Recorder  
Denise Meeves  
**Fee Book 2009-3079**

12/08/2009 @11:01AM  
PLC PLAT CORNER CER  
Book: Page: # Pages: 1  
Total Fees: \$9.00

PREPARED BY: JOSEPH P. RUESCHENBERG - SUNDQUIST ENGINEERING - 910 SEVENTH STREET, ONAWA, IOWA 51040-PHONE (712)423-3131

**UNITED STATES PUBLIC LAND SURVEY CORNER CERTIFICATE OF**  
LAND SURVEY MONUMENT SITUATED IN SECTION 22, TOWNSHIP 84 NORTH, RANGE 41 WEST  
OF THE FIFTH PRINCIPAL MERIDIAN, CRAWFORD COUNTY, IOWA.  
PREVIOUSLY RECORDED IN \_\_\_\_\_ IN COUNTY RECORDERS OFFICE.

**MONUMENT DESCRIPTION AND REMARKS**

NORTH QUARTER CORNER SECTION 22-84-41

FOUND 5/8" REBAR 0.60' DEEP.

REBAR 2.00' NORTH OF CENTERLINE OF EAST/WEST ROAD.

L. STUKENHOLTZ & R. ANDERSON

DATE 11-20-09

**PLAN VIEW**

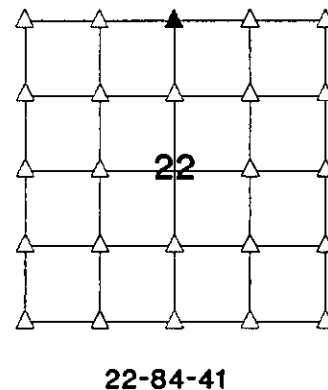
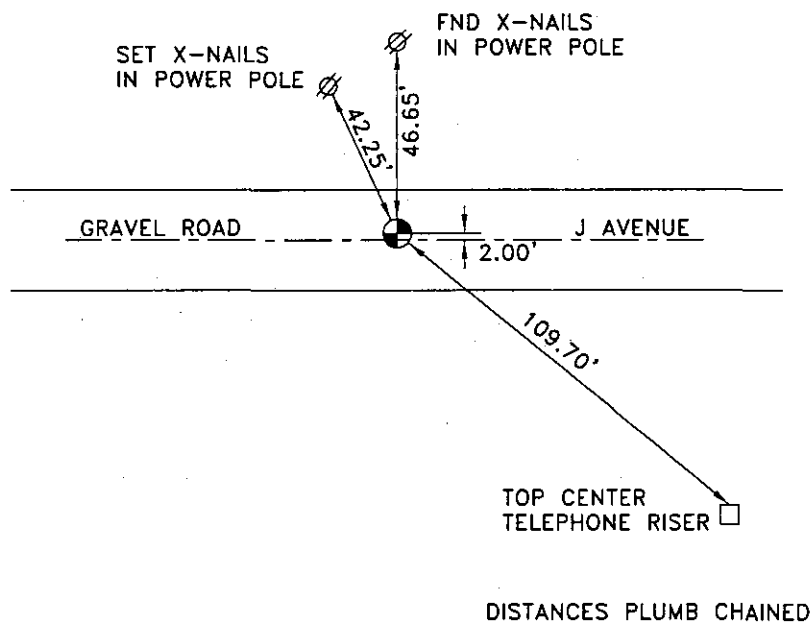

I HEREBY CERTIFY THAT THIS LAND SURVEYING DOCUMENT AND THE RELATED SURVEY WORK WAS PERFORMED BY ME OR UNDER MY DIRECT PERSONAL SUPERVISION AND THAT I AM A DULY LICENSED LAND SURVEYOR UNDER THE LAWS OF THE STATE OF IOWA.

*Joseph P. Rueschenberg*  
JOSEPH P. RUESCHENBERG

DEC 01 2009

DATE

IA. LICENSE NO. 14709

EXP. DATE DECEMBER 31, 2010

SE PROJECT NO. 23609T2

DRAWN BY: CSL

