

35 + 36

Dug 31' x 15' x 23' hole in lime

NO END

CM North 2644

CM South 2641.2

On a 1/2" line ESE

26.1 ESE = row

23.2 East 9 row Cor Post

26.8 ENE " 15" box elder

32.9 West " Cor. Post

33.2 SW " brace post

26

Dug 16" x 15" x 21' hole in lime of

fences from NTS NO END

Large cut at this place

235

Dug 9-27-39

1/2 3/4 clearing

57'

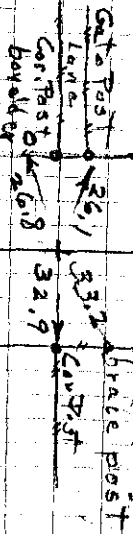

11 1/2 5

Dug 9-27-39

set in a pile with

8893 on line between

SW Cor. & SE Cor.

Trd from Sec. Cor. Cent. 5-9-92

