

7/8
 1817 Found 1 piece of lightning rod
 5" x 1/2" 16" deep. Loosened and set
 C.M. cor 15 49.5 S.E. of utility rod

Ties from X-5145 12 cor posts
 32.3 NE from W. gate post
 26.4 N. " " " " con post steel
 60.8 S.W. " " " " " "
 40.2 S.E. " " steel com posts
 49.5 S.E. " " " " " " with rod.

NE Cor. N. 1/4 Sec. 22

12-12 N

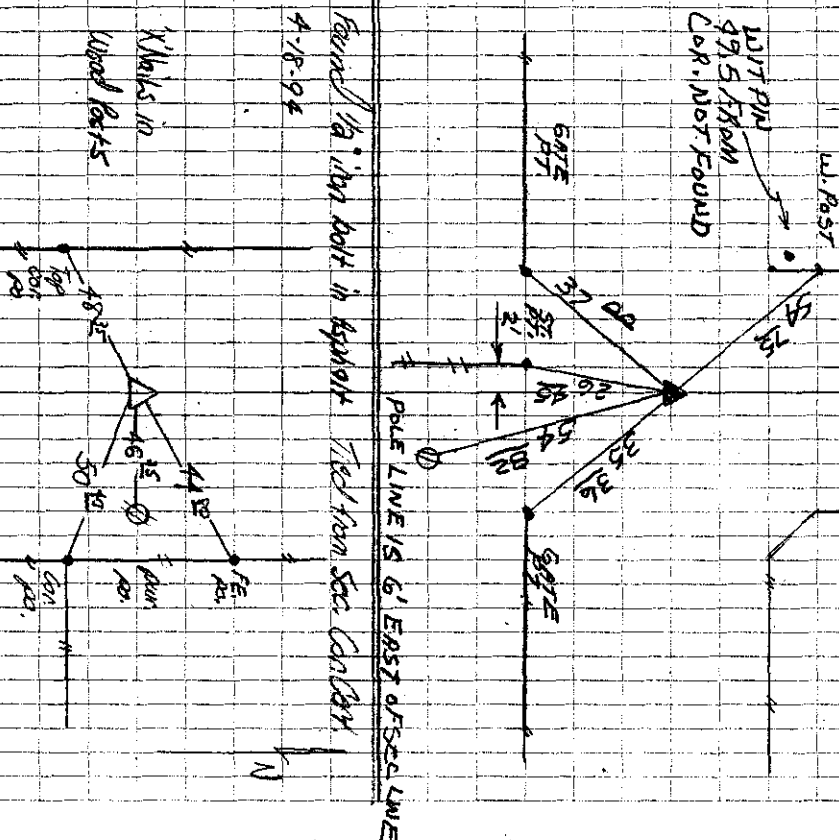

Found 1/2 1/2 inch bolt in signpost tied from Sec. Con. Cor.

4-18-92

X-links in
 Wood Posts

95
 Found 9/6/92
 10-4-01 FOUND
 CM 18" DEEP SET
 4" 6" CLEVIS PIN OVER
 IT 12" DEEP
 BERNDT LIBREY