

INDEXED DM/DM
 FOLLOW UP DM
 PROOFED SM
 SCANNED SM

Instrument #: 2021-1228
 06/04/2021 09:29:34 AM Total Pages: 1
 PLC PLAT COR CERT
 Recording Fee: \$0.00 Transfer Tax: \$0
 Denise Meeves, Recorder, Crawford County Iowa



PREPARED BY: PAUL ASSMAN-CRAWFORD COUNTY ENGINEER'S OFFICE-COURTHOUSE-DENISON, IA.-712-263-2449

UNITED STATES PUBLIC LAND SURVEY CORNER CERTIFICATE OF

LAND SURVEY MONUMENT SITUATED IN DENISON TOWNSHIP, THE SOUTHEAST CORNER OF SECTION 23, T-83N,
R-39W OF THE FIFTH P.M. CRAWFORD COUNTY, IOWA.

PREVIOUSLY RECORDED AS NO. 2001-3688

MONUMENT DESCRIPTION AND REMARKS

SOUTHEAST CORNER SEC. 23-83-39

FOUND BROKEN CONCRETE MONUMENT AND 5/8" IRON PIN. RECORDED LOCATION OF THE CENTER OF CONCRETE MONUMENT. COUNTY GRADED ROAD AND SET 5/8" REBAR WITH RED CAP #11982 1.5' DEEP OVER MONUMENT AND RETIED CORNER.

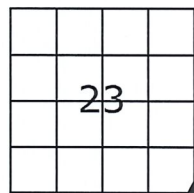

SOUTHEAST CORNER SEC. 23-83-39

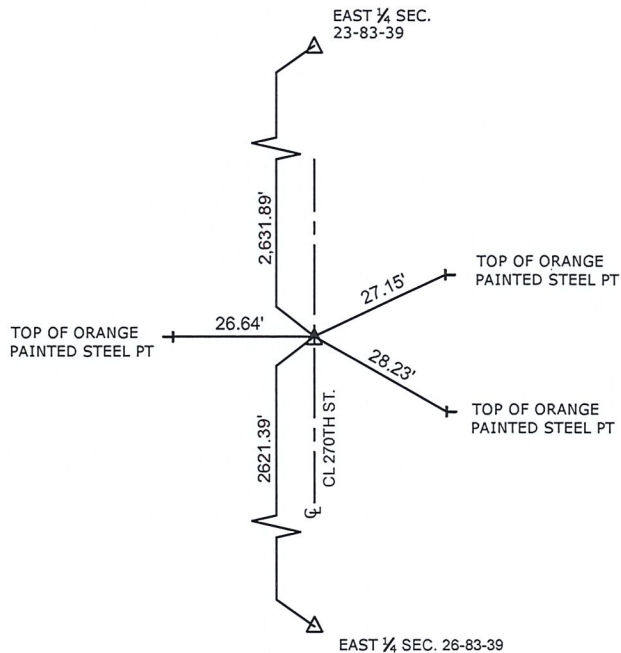

ALL DISTANCES ARE SLOPE CHAINED

CERTIFICATION:

I HEREBY CERTIFY THAT THIS LAND SURVEYING DOCUMENT WAS PREPARED AND THE RELATED SURVEY WORK WAS PERFORMED BY ME OR UNDER MY DIRECT PERSONAL SUPERVISION AND THAT I AM A DULY LICENSED LAND SURVEYOR UNDER THE LAWS OF THE STATE OF IOWA.

Paul J. Assman
Signature

5/27/21
Date of Survey

PAUL J. ASSMAN
Typed Name

11982
L.S. No.

12-31-22
License Renewal Date

Pages covered by this seal 1

