

29/38
 3233 Found brick box 5' deep.
 Lowered and set C.M.

Ties from uspts 100 cor posts
 24.0 S.S.W. from 6" box E/iden
 30.1 W.S.W. " " NW. cor of blidge
~~29.0 W.N.W. " " SW " " "~~
~~37.2 NW " " cor post~~
 80.3 NNE " " cor post f/c S.

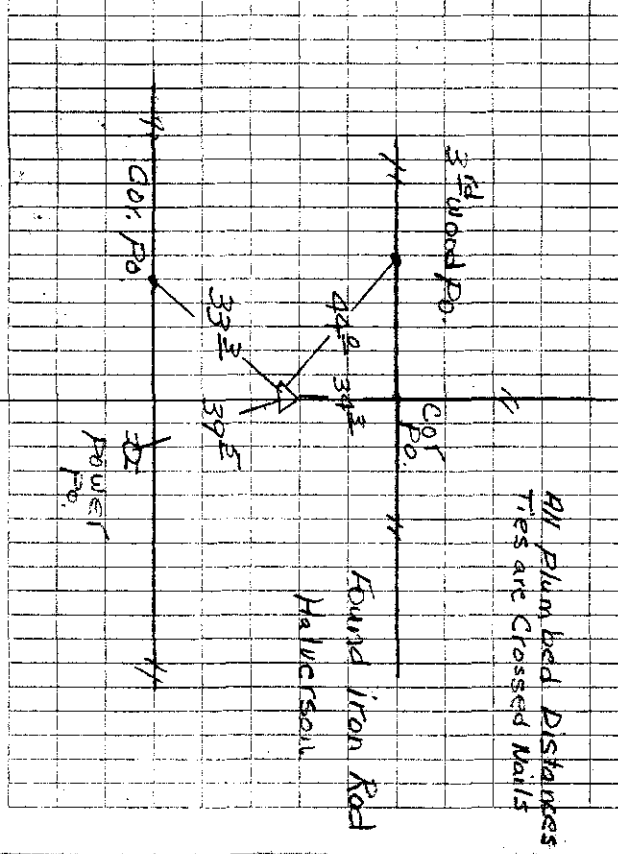
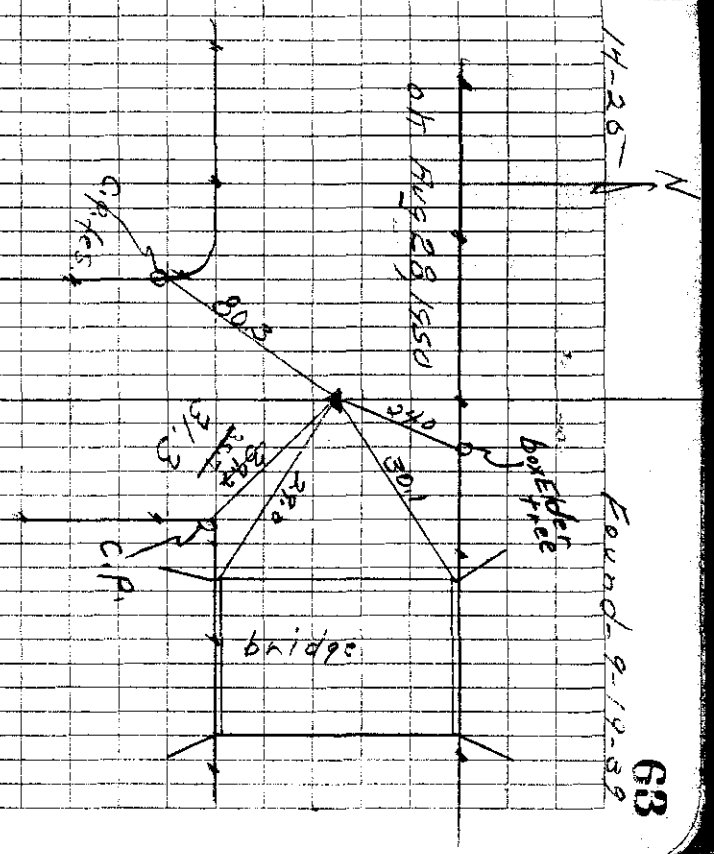

All Plumbed Distances
 Ties are Crossed Nails