

3631 DUG 2 1/2 X 8" X 13" NO FIND

~~32.5 E from CONCRETE  
26.0 SW from CONCRETE  
34.3 NW from CONCRETE~~

checked for more  
descriptions

25  
36

checked N-S EX between CTR

Set on old - 2 line N DEN 5' to lane S

at 32.8 South from Gate Post X nails

47.8 SW from Gate Post "

33.8 North from Hill Gate Post "

45.0 NE from Gate Post "

More data needed

26.2 NW FROM CONC CURBET IN LAINE CHISELED X EAST END

45.5 NE FROM BAKE POST X NAILS

35.9 SE FROM POWER POLE X NAILS

42.4 SW FROM FENCE POST X NAILS

Dec 3 1910

OK 5/12/58

6/15/92 Found

G.M. 2" deep

swank to 6" and

retired

45.00 JK 70

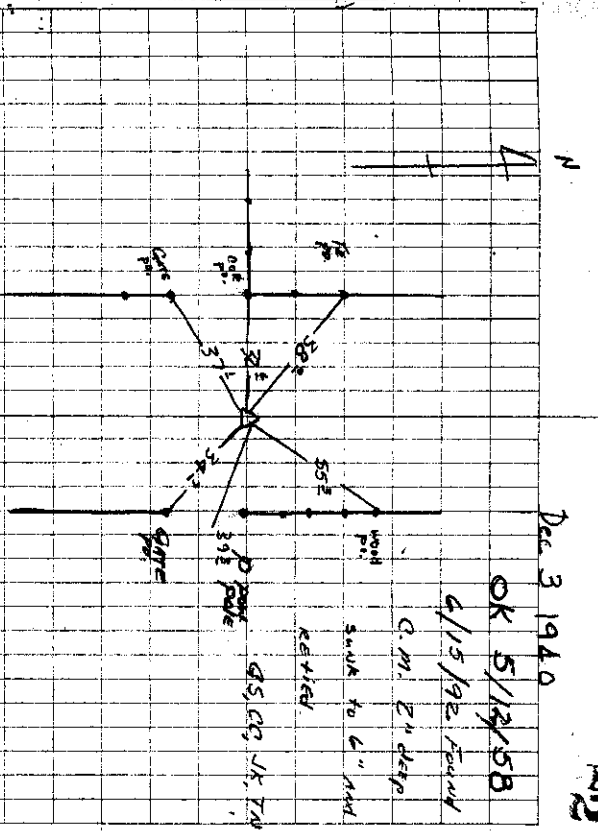

Established 12-2-'40

Found 7/27/85

CONCRETE

Found 7/24/85

LOWERED MONUMENT

TO 6" BELOW ROAD

FOUND

6-23-00  
FOUND BRACKET  
DEF CON PUT  
SPIKE ON EAST  
SIDE AND DEF  
BEHIND

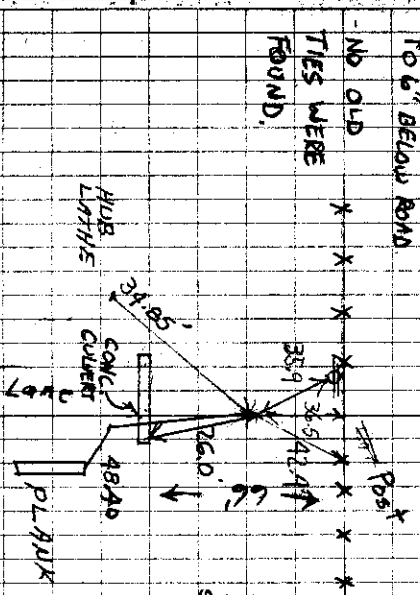

Found 7/24/85

LOWERED MONUMENT

TO 6" BELOW ROAD

FOUND