

INDEXED WJ
 FOLLOW UP WJ
 RECORDED WJ
 SIGNED WJ

□ 
 Crawford County Recorder Denise Meeves
 Fee Book 2007-0535 REC013632
 02/28/2007 8:009AM # Pages 1
 PLC PLAT CORNER CER
 Total Fees: \$7.00

PREPARED BY - JOSEPH P. RUESCHENBERG - SUNDQUIST ENGINEERING - 120 S. MAIN, DENISON, IOWA 51442 - PHONE (712) 263-8118

**UNITED STATES PUBLIC LAND SURVEY CORNER CERTIFICATE
 OF**

LAND SURVEY MONUMENT SITUATED IN SECTION 5, T 83 N, R 39 W OF
 THE 5TH P.M., CRAWFORD COUNTY, IOWA.
 PREVIOUSLY RECORDED IN BOOK _____, PAGE _____, OTHER _____

MONUMENT DESCRIPTION AND REMARKS

CENTER - SET 5/8" DIA. X 18" IRON PIN W/ORANGE CAP #14709
 FLUSH, SET FROM PREVIOUS SURVEY INFORMATION.

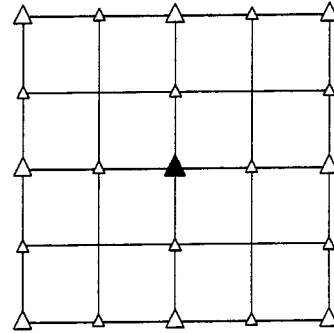

PLAN VIEW SHOWING RELATIVE LOCATION OF MONUMENT AND REFERENCE POINTS.

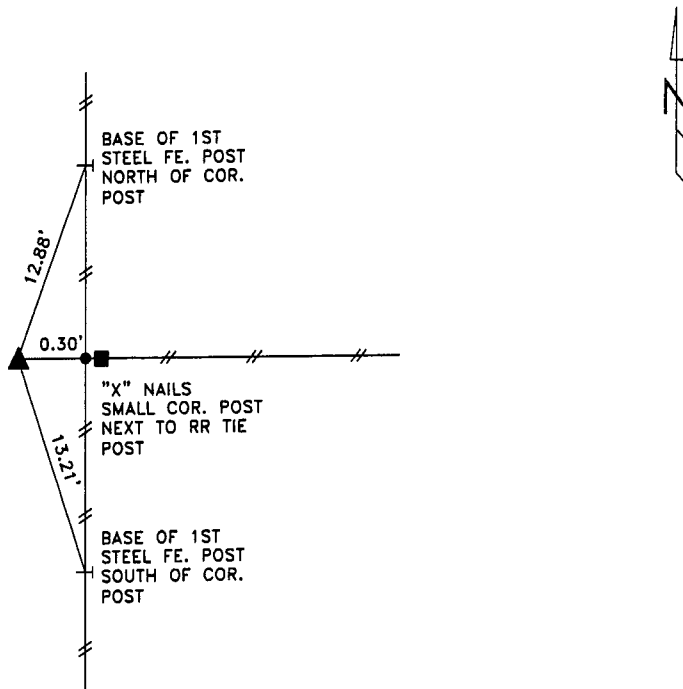

DISTANCES PLUMB CHAINED

CENTER SECTION 5-83-39

I HEREBY CERTIFY THAT THIS LAND SURVEYING DOCUMENT WAS PREPARED
 AND THE RELATED SURVEY WORK WAS PERFORMED BY ME OR UNDER MY
 DIRECT PERSONAL SUPERVISION AND THAT I AM A DULY LICENSED LAND
 SURVEYOR UNDER THE LAWS OF THE STATE OF IOWA.

Joseph P. Rueschenberg
 JOSEPH P. RUESCHENBERG

FEB 19 2007

IA LICENSE NO. 14709

DATE
 EXP. DATE DECEMBER 31, 2008

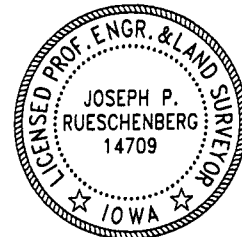

SE PROJECT NO. 20707
 DRAWN BY: LLL