

26-25

Dug 2 1/2' x 6' hole. Found lath knob 3' long  
at depth of 3'. Lowered to 4' & set CM

Ties to x spikes in cor. posts

35.8 East from Cor post

44.5 SE " 2nd steel post N

46.5 SW " REA pole

51.5 NW " cor. post

23 Dug 14' x 4' x 5 1/2' hole Found piece of  
26 stove grate & walnut stake at depth  
of 2'. In hole brick bats & rockery at  
a depth of 4'. Lowered to 4' & set CM

Ties to x spikes in cor posts

32.0 S from Steel cor post

39.4 SE " fe post

41.0 NE " " "

37.8 NW " " "

45.0 SW " " "

53 ✓

5-46-F

Notes Stammer  
Found 6-20-39

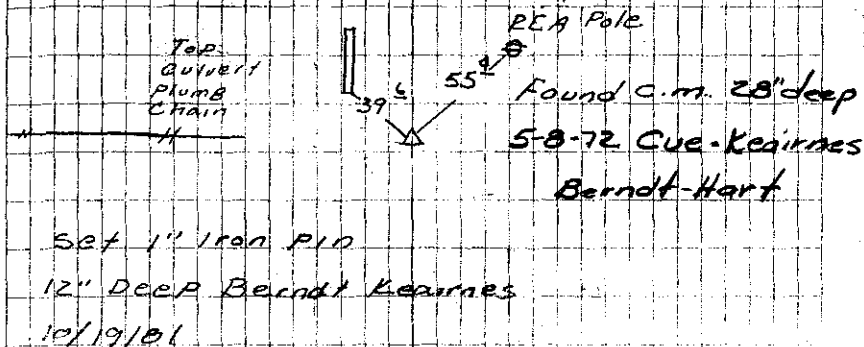

5-42-F

Notes Stammer  
Found 6-20-39

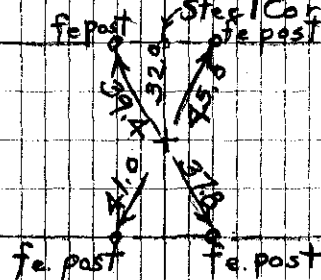

E.V.