

27 26

Dug 1/4 X 5/4 hole - no find - 5-23-39

Checked from CM's N.E.S. found
to be old straight line near
center of Rd West Old ridge
Willows N on W side of Road
Set CM Local evidence
Ties to X spikes in Car. posts

43.9 NE
41.0 SE (old ties)
27.5 West

27 Using S.R. 250 & McH Bl. 24 P.P. 38

as reference found 2 brick bats,
Walnut stake (3" x 14") 1 rock (10" x 8" x 6")
at depth of 3'. Car spikes
with local evidence. toward old
evidence set CM. flush with green
ties from X - spikes
173.4 W of 26" ash
259.0 N of main ash
C.S W of old stamp
11.3 East of post
13.8 South of marked post

31-38-5
31-27-5

5-29 Sam 13-19
Cherry

55

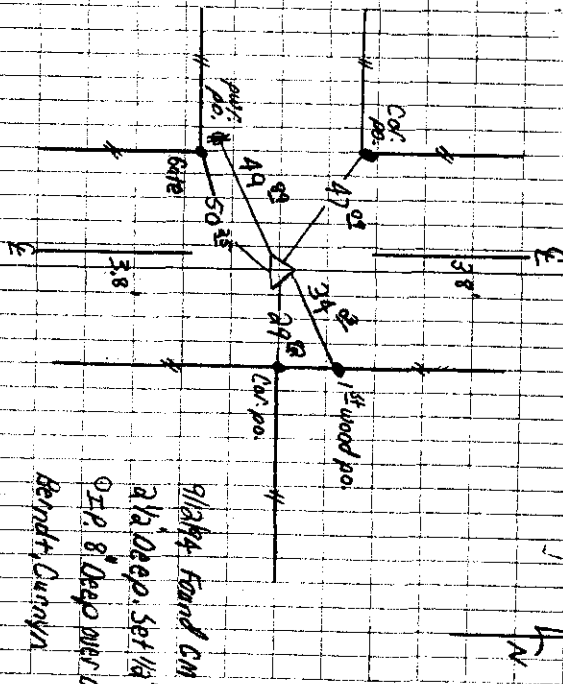

31-47-5
DIP DEER

reference to S.R. - 5-28-39
Walton - Islet
Chick - Champion

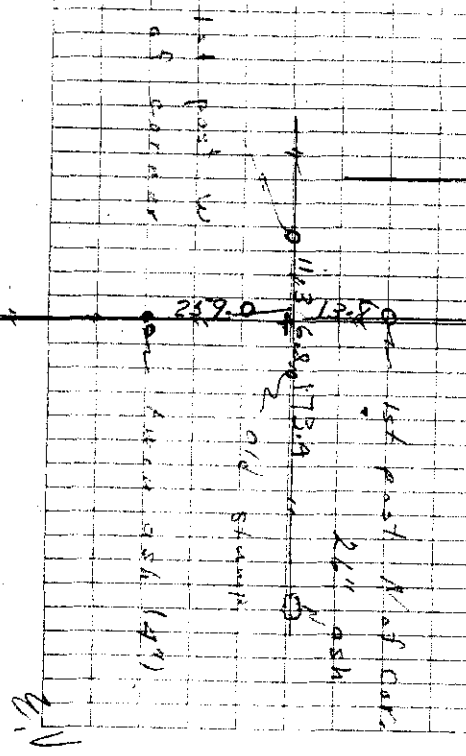

2-11