

INDEXED _____
 FOLLOW UP _____
 PROOFED WAW
 SCANNED _____

REC009293



Crawford County Recorder Denise Meeves
 REC BOOK 2006-0296 2/07/2006 @ 01:11PM
 PLC PLAT CORNER CERBook: Page: #: 1
 Total Fees: \$7.00

WILKE LAND SURVEYING 401 1800th Street Panama, Iowa 51562 (712)489-2898

UNITED STATES PUBLIC LAND SURVEY CORNER CERTIFICATE

SECTION 31 TOWNSHIP 83N RANGE 38W COUNTY CRAWFORD

Certificate Prepared For: SURVEY OF LOT 2 OF THE N1/2 NE1/4
Section 31-83-38W

Monument Description and Remarks:

Found concrete monument w/disc 1.7' deep using reference information from the Crawford County Engineers Office.

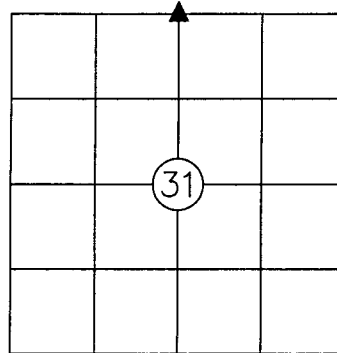

N1/4 CORNER
 SEC. 31-83-38W

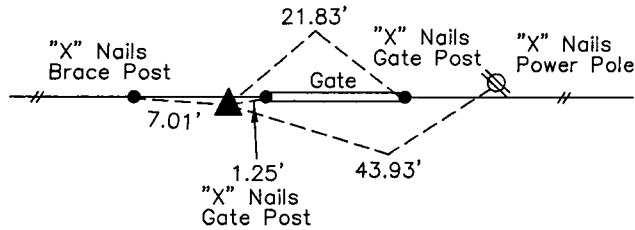

All Distances are horizontal.

FOUND CONCRETE MONUMENT WITH DISC 1.7' DEEP & 0.5' SOUTH OF BARBED WIRE FENCE.

List Corners to be Indexed			
Corner	Section	Twp.	Range
N1/4 COR.	31	83N	38W

	I hereby certify that this land surveying document was prepared and the related survey work was performed by me or under my direct personal supervision and that I am a duly licensed Land Surveyor under the laws of the State of Iowa.
	<p><u>Dean A. Wilke</u> <u>2/02/06</u></p> <p>Dean A. Wilke Date</p> <p>License number 17048</p> <p>My license renewal date is December 31, 2007</p> <p>Pages or sheets covered by this seal: <u>This page only</u></p>