

11/12 E Cor 11

Dug $2\frac{1}{2}' \times 11' \times 20'$ HOLE
IN LINE OF N&S SEC LINE FENCE
NO FIND

Ties from "X" nails in posts "plumb chained"

17.89 SE. from Brace Post

10.0 SE. from Gate Post

15.09 S.W. from Gate Post

21.55 S.W. from Brace Post

32.73 W. from iron pin in old fence

N Cor 11

2
11
Dug $2' \times 8' \times 8'$ hole ON H
INTERSECTION FENCES LARGE
BOX EDEY TREE IN CORNER UNABLE
to dig NO FIND

N $\frac{1}{4}$ 20 11 T34N R30W

At location indicated by fence intersection
dug hole 3 ft square x 12 deep.

Found walnut stake $1\frac{1}{2} \times 2 \times 6$. Adjacent to
corner was brick post $1\frac{1}{2} \times 2$ Set 11.

Ties from C.M. set 12' deep marked $\frac{2}{1}$

17.75 S. of South Gate Post

2.8 S. of Fe. Po. N.

9.0 N. of Cor. Post South

14.35 N.W. from Brace Post S.E.

26-21

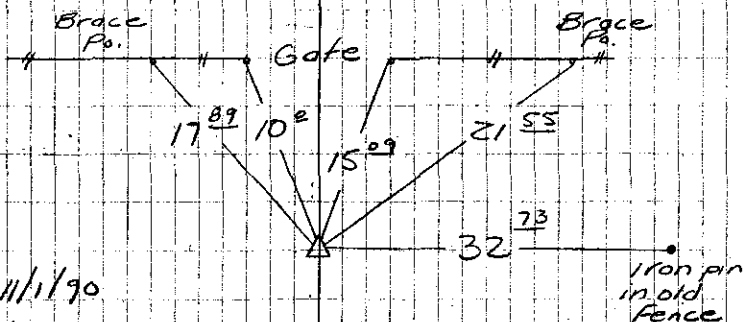

11/1/90

Set iron pin w/cap 6" deep

Ties from E. Estab. by Ia. Reg. # 4129

26-16

DUG 5' 3" x 14' 0" ✓
MESSAGE 3-19-91

Chief - Hughes
Diggers bearing 11
Plague

Dist. plumb chained

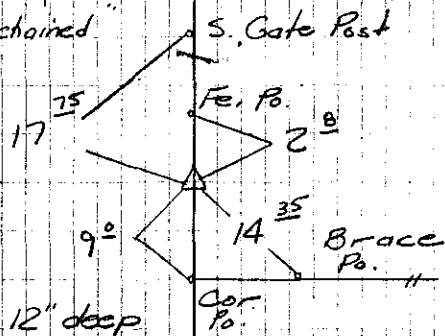

11/1/90

Found C.M. 12" deep

Ties from Iowa Reg. # 4129

E.V.