

1948

30-29 E Cor 30
description + sketch on
page 74 of this Book
with cor and $\frac{1}{4}$ cor.

61

See page 74 of this book
for description.

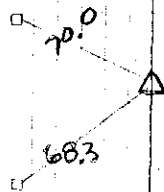

$\frac{19}{30}$ N Cor 30 1949
Sought in middle of right of way
Found wooden stake at a depth of 1'.
Lowered and set C.M.

3-38.F

found
July 5, 1951

Found 1-10-51

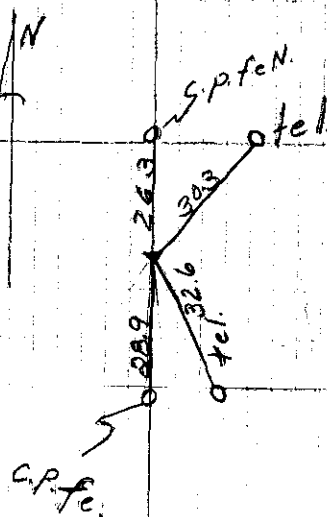

E.V.

E Cor 30

1948

Large cottonwood about 40 in size has always been used as $\frac{1}{4}$ cor marker as per C. BK #5. P# 6x7 Set C.M. directly at N. side of said tree. Also set C.M. 100.0 S. of above tree Marker in sec. fence line. And 165.7 N. of said tree Marker also set Witt. C.M. under S highway fence line on straight line of sec line fence S. C.M. at tree marked C.M. 100.0 S marked with 100.0 N. to cor C.M. 165.7 N. marked 165.7 S. to cor

ties for $\frac{1}{4}$ cor marker
 46.2 N. from cor post to S.
 100.0 W. " " tel. pole
 100.0 N. " " Witt marker
 165.7 S. " " Witt Marker

ties for S. Witt cor
 57.5 SE from tel. pole
 53.9 S " " cor. post

ties for N. Witt. Marker
 105.9 W. from tel. pole
 80.5 SSW from tel. pole
 88.8 SE from tel. pole

all markers set flush with ground

