

INDEXED DM
 FOLLOW UP _____
 PROOFED _____
 SCANNED _____

Instrument #: 2016-1850
 09/02/2016 11:20:04 AM Total Pages: 1
 PLC PLAT CORNER CER
 Recording Fee: \$7.00 Transfer Tax: \$0
 Denise Neeves, Recorder, Crawford County Iowa



PREPARED BY - JOSEPH P. RUESCHENBERG - SUNDQUIST ENGINEERING - 120 S. MAIN, DENISON, IOWA 51442 - PHONE (712) 263-8118

**UNITED STATES PUBLIC LAND SURVEY CORNER CERTIFICATE
 OF**

LAND SURVEY MONUMENT SITUATED IN SECTION 36, T 84 N, R 39 W OF
 THE 5TH P.M., CRAWFORD COUNTY, IOWA.
 PREVIOUSLY RECORDED IN BOOK _____, PAGE _____, OTHER _____

MONUMENT DESCRIPTION AND REMARKS

NE CORNER
 SW1/4 SE1/4 - SET 5/8" DIA. X 18" IRON PIN W/ORANGE CAP
 #14709 FLUSH. SET AT INTERSECTION OF THE SPLIT
 AT THE CENTER OF THE SE1/4.

SE CORNER
 SW1/4 SE1/4 - SET 5/8" DIA. X 18" IRON PIN W/ORANGE CAP
 #14709 FLUSH. SET AT SPLIT BETWEEN S1/4 COR.
 & SE COR. OF SEC. 36.

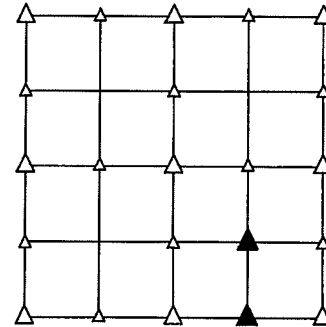

PLAN VIEW SHOWING RELATIVE LOCATION OF MONUMENT AND REFERENCE POINTS.

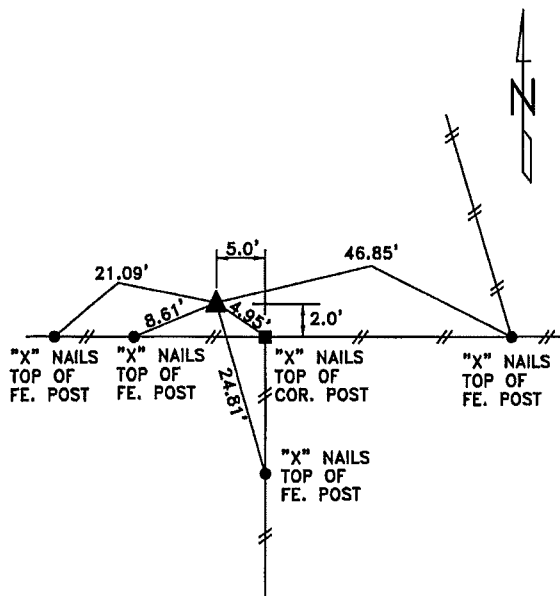

DISTANCES PLUMB CHAINED
 NE CORNER SW1/4 SE1/4
 SECTION 36-84-39

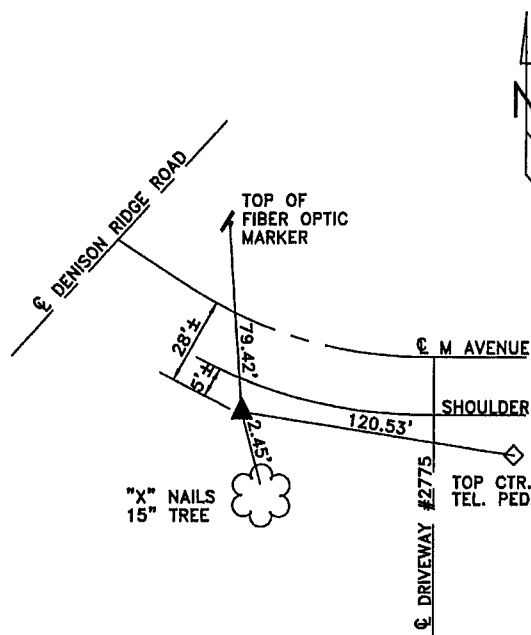

DISTANCES PLUMB CHAINED
 SE CORNER SW1/4 SE1/4
 SECTION 36-84-39

I HEREBY CERTIFY THAT THIS LAND SURVEYING DOCUMENT WAS PREPARED AND THE RELATED SURVEY WORK WAS PERFORMED BY ME OR UNDER MY DIRECT PERSONAL SUPERVISION AND THAT I AM A DULY LICENSED LAND SURVEYOR UNDER THE LAWS OF THE STATE OF IOWA.

Joseph P. Rueschenberg 9-2-2016
 JOSEPH P. RUESCHENBERG DATE

IA LICENSE NO. 14709

EXP. DATE DECEMBER 31, 2016

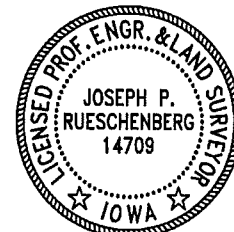

SE PROJECT NO. 23216
 DRAWN BY: LLL