

INDEXED _____
FOLLOW UP _____
PROOFED _____
SCANNED _____

Instrument #: 2018-1921
09/18/2018 01:51:26 PM Total Pages: 1
PLC PLAT CORNER CER
Recording Fee: \$0.00 Transfer Tax: \$0
Denise Meeves, Recorder, Crawford County Iowa

PREPARED BY: PAUL ASSMAN-CRAWFORD COUNTY ENGINEER'S OFFICE-COURTHOUSE-DENISON, IA.-712-263-2449

UNITED STATES PUBLIC LAND SURVEY CORNER CERTIFICATE
OF

LAND SURVEY MONUMENT SITUATED IN MILFORD TOWNSHIP, THE NORTHWEST CORNER OF SECTION 31,
T-84N, R-38W OF THE FIFTH P.M. CRAWFORD COUNTY, IOWA.

PREVIOUSLY RECORDED AS NO. 2002-3582

MONUMENT DESCRIPTION AND REMARKS

NORTHWEST CORNER SEC. 31-84-38

FOUND IRON PIN WITH YELLOW CAP (ILLEGIBLE).
COUNTY GRADED ROAD, PROJECT NO. LG48-30/31W. SET
5/8" X 14" REBAR WITH RED CAP #11982 0.8' DEEP AND
RETIED CORNER.

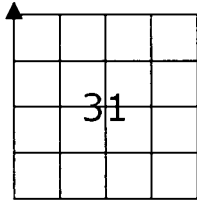

NORTHWEST CORNER SEC. 31-84-38

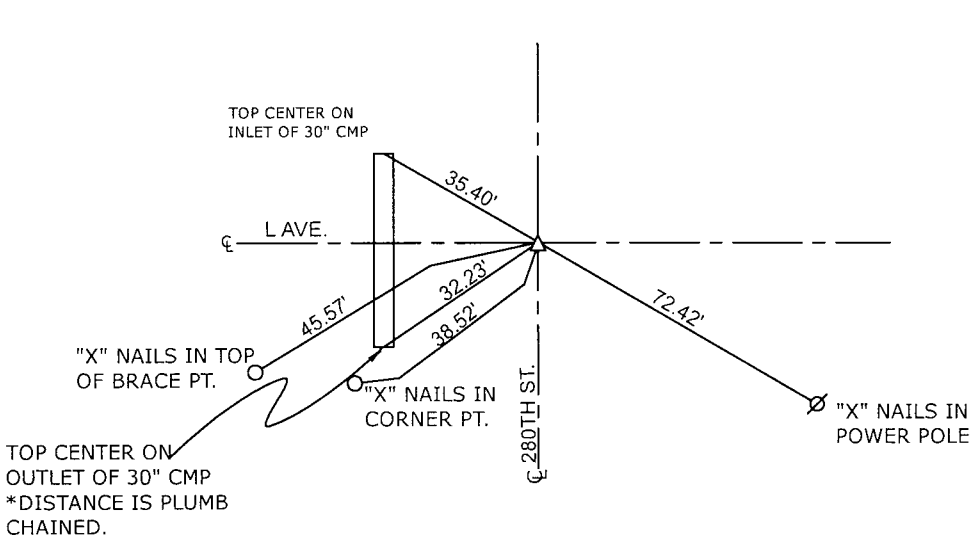

ALL DISTANCES ARE SLOPE CHAINED
UNLESS NOTED OTHERWISE

CERTIFICATION:

I HEREBY CERTIFY THAT THIS LAND SURVEYING DOCUMENT WAS PREPARED AND THE RELATED SURVEY
WORK WAS PERFORMED BY ME OR UNDER MY DIRECT PERSONAL SUPERVISION AND THAT I AM A DULY
LICENSED LAND SURVEYOR UNDER THE LAWS OF THE STATE OF IOWA.

Signature: Paul J. Assman Date of Survey: 7/31/18
PAUL J. ASSMAN 11982 12-31-18
Typed Name L.S. No. License Renewal Date

Pages covered by this seal 1

