

REC007197



INDEXED me
FOLLOW UP eg
PROOFED eg
SCANNED eg

Crawford County Recorder Denise Meeves
FEE BOOK 2005-1883 7/13/2005 @ 10:45AM
PLC PLAT CORNER CERBook: Page:05-1883 #: 1
Total Fees: \$7.00

PREPARED BY: JEFFREY M. KRUEGER L.S., KUEHL AND PAYER LTD., 423 WEST MAIN ST., SAC CITY, IA 50583 PH. (712)662-7859

UNITED STATES PUBLIC LAND SURVEY CORNER CERTIFICATE OF

LAND SURVEY MONUMENTS SITUATED IN SECTION 3, TOWNSHIP 84 NORTH,
RANGE 39 WEST, OF THE 5TH PRINCIPAL MERIDIAN, CRAWFORD COUNTY, IOWA.

PREVIOUSLY RECORDED IN BOOK _____ PAGE _____

MONUMENT DESCRIPTION AND REMARKS:

- 1.) SE CORNER NE 1/4 NE FRAC 1/4 3-84-39: FOUND 5/8" REBAR WITH YELLOW PLASTIC CAP
STAMPED "TE CRAWFORD IA RLS 8893", 4" DEEP

PLAN - VIEW

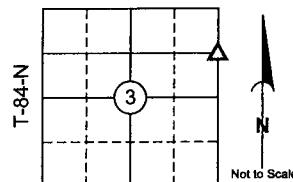

CRAWFORD COUNTY

1.) SE CORNER
NE 1/4 NE FRAC 1/4
3-84-39
FD. 5/8" REBAR WITH
YELLOW PLASTIC CAP
STAMPED "TE CRAWFORD
IA RLS 8893", 4" DEEP

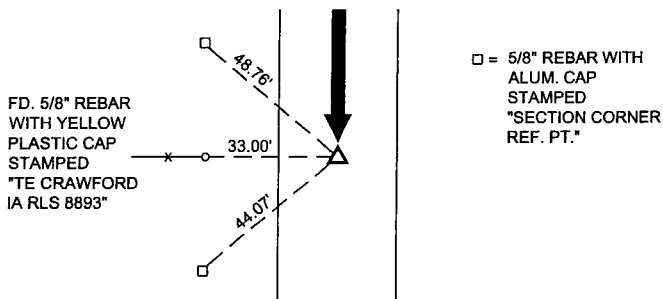

S.M. = SURVEY MARKER
PLASTIC REFERENCE DISK
AS SHOWN BELOW



I hereby certify that this land surveying document was prepared and the related survey work was performed by me or under my direct personal supervision and that I am a duly licensed Land Surveyor under the laws of the State of Iowa.

Jeffrey M. Krueger
License Number 16749
My license renewal date is December 31, 2006
Pages covered by this seal 1

Date: 6-28-2005

List Corners to be Indexed

Corners	Section	Township	Range
1) SE NE 1/4 NE FRAC 1/4	3	84	39

PN: 050573
DRAWN: GMV