

2001 08 10 AM 10:56 INDEXED
 INST. NO. 2001-2899 FOLLOW UP 2/02
 DENISE REEVES, RECORDER
 Denise Reeves
 SEE no file

PREPARED BY: MICKAEL BERNDT
 CRAWFORD COUNTY ENGINEERS OFFICE - COURTHOUSE - DENISON, IA. - 712-263-2449

**UNITED STATES PUBLIC LAND SURVEY CORNER CERTIFICATE
 OF**

LAND SURVEY MONUMENT SITUATED BETWEEN SECTIONS 13 & 24, T 84 N, R 40 W OF
 THE 5TH P.M. CRAWFORD COUNTY, IOWA.

PREVIOUSLY RECORDED IN BOOK N/A, PAGE, OTHER

MONUMENT DESCRIPTION AND REMARKS

SOUTH 1/4 CORNER SEC. 13-84-40

This corner was not set by the government surveyors during the original survey of Hanover Township. In March 1921 a Plat of Survey for the SESW was filed in the Recorders Office to be found in the Auditors Office Book B Page 449. This Plat was for taxation and assement purposes. I compared the distances given on the Subdivision Plat and the distances given in Road Petition #1223 filed in the Auditors Office in 1918 to an established old cedar corner post with cross fences that was found and has been the boundary line for over 80 years. The called out distance from the Plat of Survey as compared to the actual distance is within 6.7 feet. I feel confident in establishing the Sec. Corner at the intersection of the existing fences, since this is what the intent of the Subdivision Plat was and has not been disputed for at least 80 years.

SOUTH 1/4 CORNER SEC. 13-84-40
 SET 5/8" X 18" REBAR
 YELLOW CAP #14808
 1" ABOVE EXISTING GROUND LINE

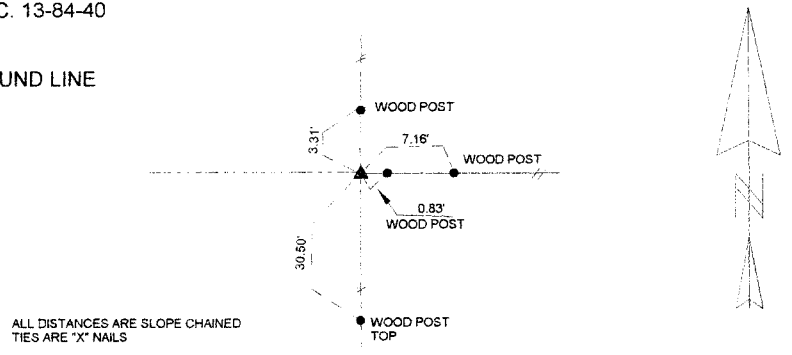

CORNER: S1/4
 SECTION: 13
 TOWNSHIP: 84N
 RANGE: 40W

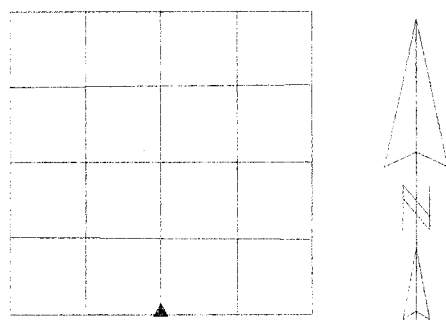

I HEREBY CERTIFY THAT THIS LAND SURVEYING DOCUMENT WAS PREPARED AND THE RELATED SURVEY WORK WAS PERFORMED BY ME OR UNDER MY DIRECT PERSONAL SUPERVISION AND THAT I AM A DULY LICENSED LAND SURVEYOR UNDER THE LAWS OF THE STATE OF IOWA.

Mickael Berndt 10-10-01
 MICKAEL BERNDT DATE
 IA. LICENSE NO. 14808 EXP. DATE 12-31-02

