

N. 2nd sec - 22-84-40  
Dog Hill ridge in line of  
N.Y.S. fence. No find  
More data needed here.

Ties from X nails  
91.2 N.W. corner 1st pole  
33.5 SW corner E. side post  
87.7 W.S.W. " 1st pole  
2-2.6 North from Cor post

27-26 DUG 122x44x26 HOLE IN LINE  
OF FENCE FROM W. FOUND REMAINS  
OF OLD PLANK BRIDGE IN LINE WITH  
FENCE FROM W ALSO. NO OUT ON HIGH  
SIDE OF ROAD NO FIND  
lines with to E. on S.W. W

Ties to X nails  
2-2.0 E from Cor Post  
27.9 NE " 59th post  
30.9 NW from 90 post  
25.9 SW " "

2-70-5

S. # 1017194

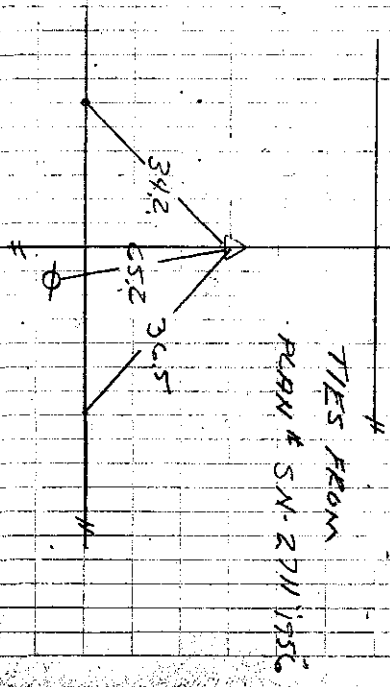

8-11-5

DUG 7-18-59

Set 1-6-44  
cherry

10/30/84  
Revised  
Remains  
Bench at

Dent in  
10 cent  
Bench

SWING TOP  
ELECT. BOX

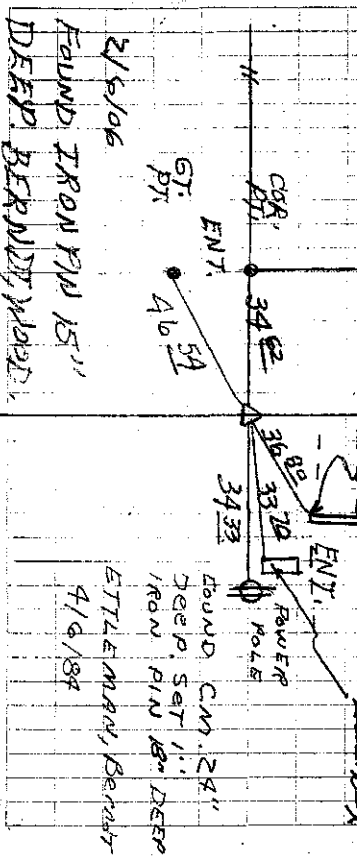

FOUND CM. 28"  
DGEIP. SET 11"  
IRON PIN 18" DEEP  
LITTLE MAN, BENCH  
4/9/84