

Crawford County Recorder
Denise Meeves
Fee Book 2008-2425

08/25/2008 09:32AM
PLC: PLAT CORNER CER
Book: Page: # Pages: 1
Total Fees: \$7.00

INDEXED
FILED
RECORDED
SEARCHED

Lee O. Gallentine LS, Ryken Engineering, 511 Bank St., Webster City, IA 50596 - Ph. 515-832-1878 - Fax 515-832-1932

UNITED STATES PUBLIC LAND SURVEY CORNER CERTIFICATE
OF

Land Survey Monuments situated in Section 18, Township 83 North,
Range 37 West, of the Fifth Principal Meridian, Crawford County, Iowa,
Previously recorded in Inst. #2002-3978 in County Recorder's Office

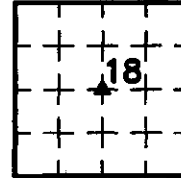

This corner was used for a survey in this section for Ray P. and Carol A. Lenz and Larry W. and Jean A. Boeckman. Basis of bearing for this corner cert. can be found on the associated plat of survey filed in the Co. Rec's Office for this section.

Legend

BC = Nail with Bottle Cap	ID = Inside Diameter	R/W = Iron ROW Nail
BP = Brace Post	OD = Outside Diameter	SFP = Steel 'T' Post
CP = Corner Post	PP = Power Pole	SW = Nail with Square Metal Washer
CMP = Corrugated Metal Pipe	PW = Nail with Yellow Plastic Washer	TP = Telephone Pedestal
CM = 4" Sq Concrete Monument with	RCP = Reinforced Concrete Pipe	TW = Nail with Round Metal Washer
1/2" iron rod in center (tie to rerod)	RH = Red Head (Nail in wire)	WFP = Wood Fence Post
CX = Cut 'X'	ROW = Right of Way	X = X Nails
GP = Gate Post	RW = Nail with Reflective Round Washer	

Center

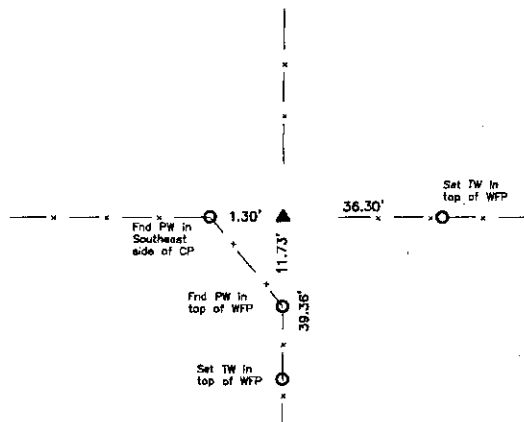

Monument Description, Remarks, and Plan View:

Center - History of Corner =

1909, Sep. 7 - 'Lime Stone + Brick Bats' per Co. Engr's MC Field Bk 59 Pg 58.
2002, Dec. 2 - 'SET 3/8" REBAR WITH RED PLASTIC CAP STAMPED "S. SHEVEL 118°10"' by J Scott Shevel per Co. Rec's Inst. #2002-3976 and Inst. #2002-3978.

Co Engr's previous and current ties do not indicate that corner is monumented.

Corner Recovery =

Searched area with metal detector and found 3/8" red capped iron rerod (#11810) 0.3' exposed on southwest side of cut off power pole in-line with fencelines West and South, 0.5'± West of fenceline North, and 0.5'± South of fenceline East. Searched 1.0' x 4.0' deep area around rerod with tile probe and found nothing. Excavated 1.5' x 2.0' deep hole around corner post and found nothing. Searched hole to 4.5'± deep with tile probe and found nothing. Monument found matches that of record and record ties are within reason. Therefore, used rerod as the correct corner. All ties are plumb distance unless indicated otherwise.

This certificate is being prepared because there are no longer three valid ties of record.



I hereby certify that this land surveying document was prepared and the related survey work was performed by me or under my direct personal supervision and that I am a duly licensed land surveyor under the laws of the State of Iowa.

LEE O. GALLENTINE, LS
Date: July 25, 2008 license number. 15745
My license renewal date is December 31, 2008

Pages or sheets covered by this seal: 1

List Corners to be Indexed

Corners	Section	Twp	Range
Center	18	T83N	R37W

Pg 1 of 1

P:\808\CRAWFORDCO\S188337\PRESTAGE4668.dwg\4668cornercert.dwg