

Sara Meseck, RECORDER  
 Crawford County, Iowa  
 Instr. Number: 2026-0329  
 Recorded: 2/18/2026 at 8:02:48.0 AM  
 Pages 1  
 County Recording Fee: \$7.00  
 Iowa E-Filing Fee: \$3.13  
 Combined Fee: \$10.13  
 Revenue Tax:

PREPARED BY AND RETURN TO: MIKE SCHULTE, SCHULTE SURVEYING, INC., 2003 390TH STREET, WESTSIDE, IA 51467 (712) 790-3489

**UNITED STATES PUBLIC LAND SURVEY CORNER CERTIFICATE OF**  
 LAND SURVEY MONUMENTS SITUATED IN SECTION 13, TOWNSHIP 82 NORTH, RANGE 37 WEST, OF THE FIFTH  
 PRINCIPAL MERIDIAN, CRAWFORD COUNTY, IOWA. PREVIOUSLY RECORDED IN SEE BELOW IN COUNTY  
 RECORDER'S OFFICE. (book, page instrument number)

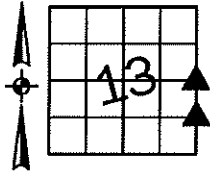

**NE CORNER SE1/4 SE1/4**  
 SET 5/8" REBAR YPC #17979

N=7205577.97 E=16674369.17 Z=1427.05  
 NO RECORD OF CORNER FOUND. CALCULATED POSITION BY  
 SINGLE PROPORTION, SEARCHED AREA. FOUND NOTHING. SET  
 5/8" REBAR YPC #17979. VERIFIED WITH SURROUNDING  
 FIELD EVIDENCE.  
 THIS CERTIFICATE IS BEING FILED DUE TO NONE OF RECORD.

**E1/4 CORNER**  
 FND BOAT SPIKE 3" DEEP

N=7406580.24 E=17374950.96 Z=1431.07  
 USED CERTIFICATE RECORDED IN INSTRUMENT #001313 IN CARROLL  
 COUNTY AND A METAL LOCATOR TO FIND A BOAT SPIKE 3" DEEP.  
 VERIFIED WITH 2 REMAINING TIES.  
 THIS CERTIFICATE IS BEING FILED TO UPDATE THE REFERENCE TIES.

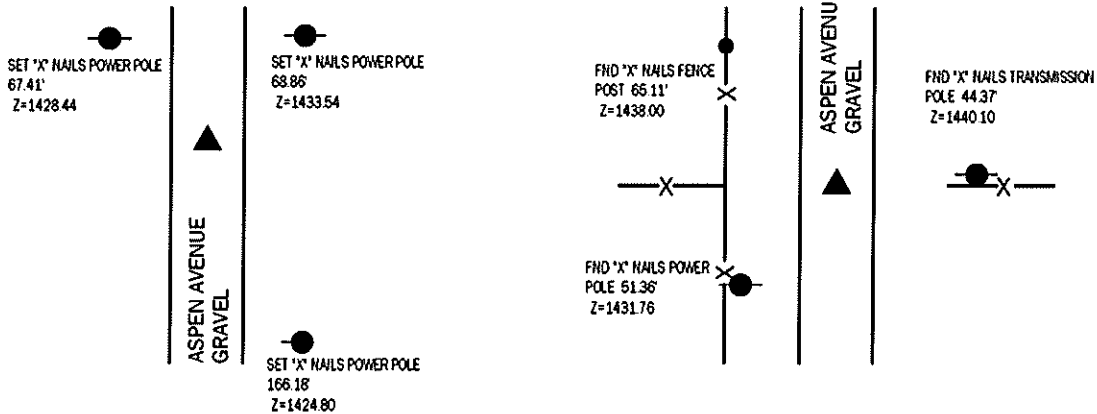

\*All distances are measured horizontally unless noted.

I HEREBY CERTIFY THAT THIS LAND SURVEYING DOCUMENT WAS  
 PREPARED BY ME OR UNDER MY DIRECT PERSONAL SUPERVISION AND  
 THAT I AM A DULY LICENSED PROFESSIONAL LAND SURVEYOR UNDER  
 THE LAWS OF THE STATE OF IOWA.

*Mike Schulte*  
 MIKE SCHULTE  
 LICENSE NUMBER 17979  
 LICENSE RENEWAL DATE IS DECEMBER 31, 2027  
 PAGES COVERED BY THIS SEAL: 1 OF 1  
 DATE 2026/02/17



**LIST CORNERS TO BE INDEXED**

CORNER	SECTION	TWP	RANGE
E1/4 CORNER	13	82	37
NE CORNER SE1/4 SE1/4	13	82	37

**BASIS OF BEARING**

1aRCS ZONE 6 - US SURVEY FEET  
 1aRTH DERIVED - NAD83(2011)(EPOCH 2010.00)

**SCHULTE SURVEYING, INC.**

DRAWN BY: SLG  
 PROJ NUMBER: 26-026