

INDEXED *me*  
 FOLLOW UP *me*  
 PROOFED *me*  
 SCANNED *y*

REC009771 

Crawford County Recorder Denise Meeves  
 FEE BOOK 2006-0735 3/20/2006 @ 11:16AM  
 PLC PLAT CORNER CERBook: Page: #: 1  
 Total Fees: \$.00

PREPARED BY: MICKAEL BERNDT  
 CRAWFORD COUNTY ENGINEERS OFFICE - COURTHOUSE - DENISON, IA. - 712-263-2449

**UNITED STATES PUBLIC LAND SURVEY CORNER CERTIFICATE  
 OF**

LAND SURVEY MONUMENT SITUATED IN IOWA TOWNSHIP, THE NORTH 1/4  
 CORNER OF SECTION 14, T-82N, R-37W OF THE 5TH P.M. CRAWFORD COUNTY, IOWA.

PREVIOUSLY RECORDED AS NO.

**MONUMENT DESCRIPTION AND REMARKS**

NORTH 1/4 CORNER SEC. 14-82-37

3/07/06  
 ACCORDING TO THE RECORDS IN THE COUNTY ENGINEERS OFFICE NO MONUMENT WAS SET AT THIS LOCATION. THE CORNER WAS ESTABLISHED ON A STRAIGHT LINE BETWEEN THE NE CORNER AND THE NW CORNER OF SECTION 14 AND A SPLIT OF THE DISTANCE BETWEEN THEM. THIS AGREED VERY CLOSELY WITH THE PRESENT FENCE LINES. A 5/8" X 14" REBAR WITH YELLOW CAP NO. 14808 WAS SET 8" DEEP AND TIED OFF.

NORTH 1/4 CORNER SEC. 14-82-37

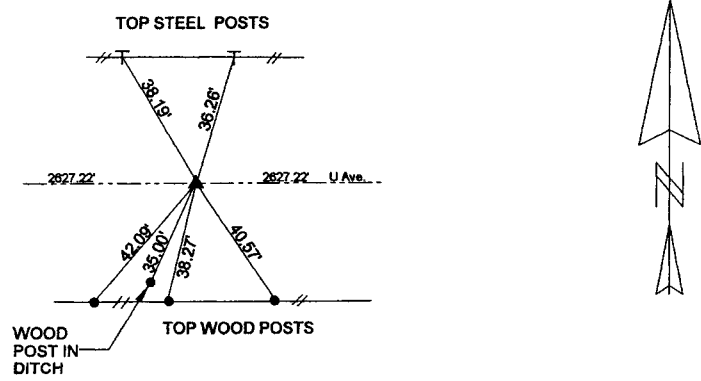

ALL DISTANCES ARE SLOPED CHAINED

All ties are "X" nails.

CORNER: NORTH 1/4  
 SECTION: 14  
 TOWNSHIP: 82N  
 RANGE: 37W

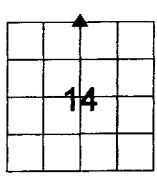

CERTIFICATION:  
 I HEREBY CERTIFY THAT THIS LAND SURVEYING DOCUMENT WAS PREPARED AND THE RELATED SURVEY WORK WAS PERFORMED BY ME OR UNDER MY DIRECT PERSONAL SUPERVISION AND THAT I AM A DULY LICENSED LAND SURVEYOR UNDER THE LAWS OF THE STATE OF IOWA.

*Michael F. Berndt* 3-20-06  
 Signature Date of Survey

Mickael F. Berndt 14808 Dec. 31, 2006  
 Typed Name L.S. No. License Renewal Date

Pages covered by this seal: 1

