

INDEXED
 FOLLOWING PAGE
 RECORDED

FILED DENISON, IOWA
 CRAWFORD COUNTY

2003 MAY 12 AM 11:10

INS. NO. 2003-1779
 DENISE MEYER, RECORDER
Denise Meyer
 EFF. 10/01/02

PREPARED BY: MICKAEL BERNDT
 CRAWFORD COUNTY ENGINEERS OFFICE - COURTHOUSE - DENISON, IA. - 712-263-2449

UNITED STATES PUBLIC LAND SURVEY CORNER CERTIFICATE
OF

LAND SURVEY MONUMENT SITUATED IN IOWA TOWNSHIP, THE NORTH 14
 CORNER OF SECTION 28, T-82N, R-37W OF THE 5TH P.M. CRAWFORD COUNTY, IOWA.

MONUMENT DESCRIPTION AND REMARKS

NORTH 14 CORNER SEC. 28-82-37

In 1940 the Section Corner was sought, but no corner was found or set. In April 2003 we needed the corner for County Project No. LWC27-28N. The Northeast Corner and the Northwest Corner of Sec. 28 were located and a pin was set at the midpoint and on line between the two corners. This correlated with the split of the fences. There are no fences that range north or south.

NORTH 14 CORNER SEC. 28-82-37
 SET 5/8" X 16" REBAR WITH
 YELLOW CAP #14808
 8" DEEP

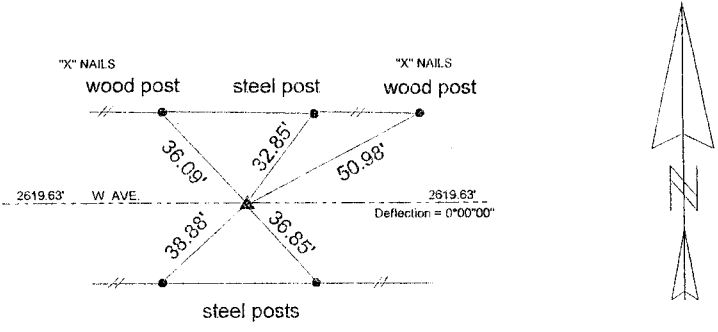

CORNER: NORTH 14
 SECTION: 28
 TOWNSHIP: 82N
 RANGE: 37W

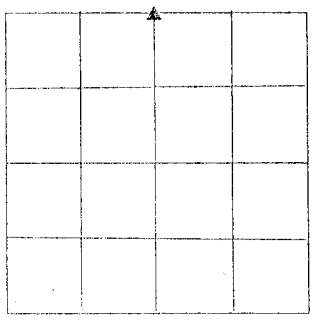

I HEREBY CERTIFY THAT THIS LAND SURVEYING DOCUMENT WAS PREPARED
 AND THE RELATED SURVEY WORK WAS PERFORMED BY ME OR UNDER MY
 DIRECT PERSONAL SUPERVISION AND THAT I AM A DULY LICENSED LAND
 SURVEYOR UNDER THE LAWS OF THE STATE OF IOWA.

Mickael F. Berndt 5-12-03
 MICKAEL F. BERNDT DATE
 IA. LICENSE NO. 14808 EXP. DATE 12-31-04

