

33 $S\frac{1}{4}$ Cor of Sec 33-82-37
 4 Dug 2'x4'x20' hole in line of fences from N & S.

D.D not find corner.

10-25-39 Found piece of strep iron.

$\frac{1}{2}$ "x $\frac{1}{2}$ " brick bats & cracker of brown jug (found)

of flat nails at a depth of 20" covered & set cm

Ties from X-spots in Cor posts

25.0 SE from N gate po.

20.4 S " Cor post

20.5 N " Cor post

38.9 NE " 12" Box elder

39 $S\frac{1}{4}$ Cor of Sec 39-82-37

3 Found 7 small limestone 12" deep.

1 limestone 2"x6"x14" at a depth of 10", 19 small

pieces of brick 18" deep. Spruce & soft pine.

Ties from X-spots in Cor posts

23.0 S. from Cor post

25.3 N. " "

28.6 N.NE " W gate post

50.1 NW " 6" mulberry

Book 17, p.34

Sought 9-14-39
 Set 10-25-39

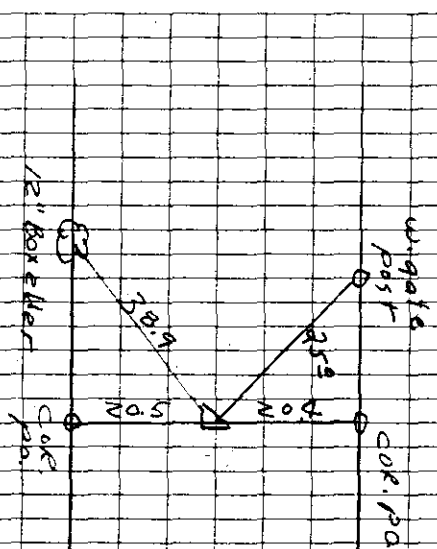

Found 10-25-39
 Note & R. Sharrow et
 copy - Champaign

