

Sara Meseck, RECORDER
 Crawford County, Iowa
 Instr. Number: 2026-0420
 Recorded: 3/3/2026 at 3:59:25.0 PM
 Pages 1
 County Recording Fee: \$7.00
 Iowa E-Filing Fee: \$3.13
 Combined Fee: \$10.13
 Revenue Tax:

PREPARED BY AND RETURN TO: MIKE SCHULTE, SCHULTE SURVEYING, INC., 2003 390TH STREET, WESTSIDE, IA 51467 (712) 790-3489

UNITED STATES PUBLIC LAND SURVEY CORNER CERTIFICATE OF
 LAND SURVEY MONUMENTS SITUATED IN SECTION 27, TOWNSHIP 82 NORTH, RANGE 37 WEST, OF THE FIFTH
 PRINCIPAL MERIDIAN, CRAWFORD COUNTY, IOWA. PREVIOUSLY RECORDED IN SEE BELOW IN COUNTY
(book, page instrument number)
 RECORDER'S OFFICE.

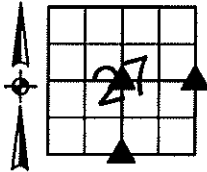

E1/4 CORNER
 FND MAG NAIL

N=7196391.43 E=16663861.89 Z=1454.00
 NO RECENT RECORD OF CORNER FOUND. ROAD IS NOW PAVED.
 SEARCHED AREA WITH A METAL LOCATOR, FOUND NOTHING. SET
 MAG NAIL IN ROAD CENTERLINE BY SPLIT OF NE CORNER AND SE
 CORNER. VERIFIED WITH SURROUNDING FIELD EVIDENCE.
 THIS CERTIFICATE IS BEING FILED DUE TO NONE OF RECORD.

S1/4 CORNER
 FND 80D NAIL 3" DEEP

N=7193740.32 E=16661234.38 Z=1374.05
 USED COUNTY ENGINEER'S TIES AND A METAL LOCATOR TO FIND AN
 80D SPIKE 3" DEEP. VERIFIED WITH SURROUNDING FIELD EVIDENCE.
 THIS CERTIFICATE IS BEING FILED DUE TO NONE OF RECORD.



SET 'X' NAILS IN FENCE POST
 48.72
 N=7193708.05
 E=16661197.88
 Z=1371.83

SET MAG NAIL IN CMP
 32.00
 N=7193714.26
 E=16661262.95
 Z=1372.42

SET MAG NAIL IN CMP
 49.74
 N=7193714.30
 E=16661276.77
 Z=1373.20

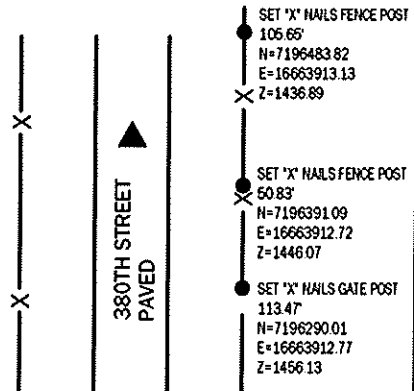

CENTER

SET 5/8" REBAR YPC #17979 FLUSH WITH GROUND
 N=7196373.71 E=16661225.00 Z=1475.90
 NO RECORD OF MONUMENT FOUND. THERE IS A LARGE ALUMINUM
 SWITCHING TOWER HERE. CALCULATED POINT BY INTERSECTION AND IT
 LANDS ON WEST FENCE, 2' WEST OF FENCE SOUTH, SIMILAR TO S1/4
 CORNER. SET 5/8" REBAR YPC #17979 FLUSH WITH THE GROUND.
 THIS CERTIFICATE IS BEING FILED DUE TO NONE OF RECORD.

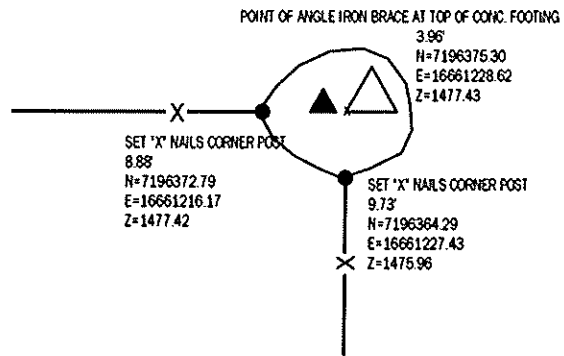

LIST CORNERS TO BE INDEXED

CORNER	SECTION	TWP	RANGE
S1/4 CORNER	27	82	37
N1/4 CORNER	34	82	37
CENTER	27	82	37
E1/4 CORNER	27	82	37
W1/4 CORNER	26	82	37

*All distances are measured horizontally unless noted.

I HEREBY CERTIFY THAT THIS LAND SURVEYING DOCUMENT WAS
 PREPARED BY ME OR UNDER MY DIRECT PERSONAL SUPERVISION AND
 THAT I AM A DULY LICENSED PROFESSIONAL LAND SURVEYOR UNDER
 THE LAWS OF THE STATE OF IOWA.

Mike Schulte
 MIKE SCHULTE
 LICENSE NUMBER 17979
 LICENSE RENEWAL DATE IS DECEMBER 31, 2027
 PAGES COVERED BY THIS SEAL: 1 OF 1



BASIS OF BEARING

14RCS ZONE 6 - US SURVEY FEET
 14RTN DERIVED - NAD83(2011)(EPOCH 2010.00)

SCHULTE SURVEYING, INC.

DRAWN BY: SLG
 PROJ NUMBER: 26-033