

98 JAN 16 AM 10:08

INST. NO. 98-0129  
DENISE MEEVES, RECORDER  
*Denise Meeves*  
FEE \$ 6.00

This document prepared by: Semke & Associates - 712-792-2276  
Michael G. Semke, L.S.#10318 - 608 N. Court St., Carroll, Iowa

UNITED STATES PUBLIC LAND SURVEY CORNER CERTIFICATE  
OF

Land Survey Monuments situated in Section 35, Township 82, Range 37, of the Fifth Principal Meridian, Crawford County, Iowa. Previously recorded in \_\_\_\_\_ in County Recorder's Office.  
(book, page, document number, etc.)

(Show reason for preparing this certificate, the evidence and detailed procedures used in establishing the corner positions and monumentation found or placed.)

PLAN - VIEW

(Show a minimum of three reference ties to durable physical objects, relevant monuments and physical conditions that will enable recovery of the corner.)

N 1/4 COR  
35-82-37

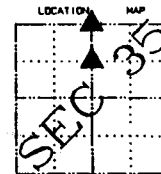
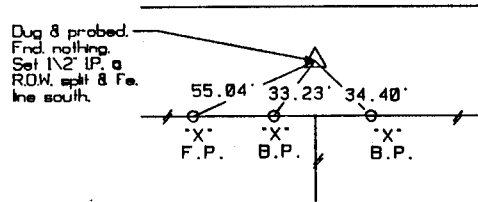

SE COR  
NE 1/4 NW 1/4  
35-82-37

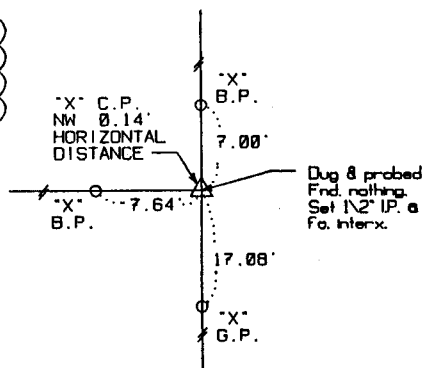

Note: All ties slope chained unless noted.

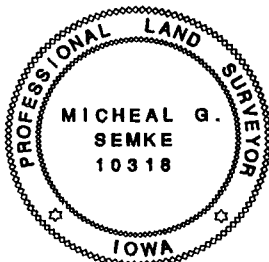

I HEREBY CERTIFY THAT THIS CORNER CERTIFICATE WAS PREPARED BY ME OR UNDER MY DIRECT PERSONAL SUPERVISION AND THAT I AM A PROFESSIONAL LAND SURVEYOR UNDER THE LAWS OF THE STATE OF IOWA. MY REGISTRATION IS SUBJECT TO RENEWAL 12-31-99.

1-15-98  
DATE

*Michael G. Semke*  
MICHAEL G. SEMKE, RLS NO 10318

List Corners to be Indexed

Corners	Section	Twp	Range
N 1/4	35	82	37
S 1/4	26	82	37
SE COR			
NE 1/4 NW 1/4	35	82	37
SW COR			
NW 1/4 NE 1/4	35	82	37