

Sara Meseck, RECORDER
 Crawford County, Iowa
 Instr. Number: 2025-0957
 Recorded: 5/14/2025 at 3:55:42.0 PM
 Pages 1
 County Recording Fee: \$7.00
 Iowa E-Filing Fee: \$3.13
 Combined Fee: \$10.13
 Revenue Tax:

PREPARED BY AND RETURN TO: MIKE SCHULTE, SCHULTE SURVEYING, INC., 2003 390TH STREET, WESTSIDE, IA 51467 (712) 790-3489

UNITED STATES PUBLIC LAND SURVEY CORNER CERTIFICATE OF
 LAND SURVEY MONUMENTS SITUATED IN SECTION 05, TOWNSHIP 82 NORTH, RANGE 37 WEST, OF THE FIFTH
 PRINCIPAL MERIDIAN, CRAWFORD COUNTY, IOWA. PREVIOUSLY RECORDED IN SEE BELOW IN COUNTY
 RECORDER'S OFFICE. (book, page instrument number)

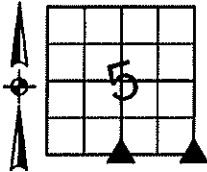

S1/4 CORNER

FND 5/8" REBAR YPC #6806

N=7214766.64 E=16650607.44 Z=1407.90

USED CERTIFICATE RECORDED IN INSTRUMENT #2014-1878 AND A METAL LOCATOR TO FIND A 5/8" REBAR YPC #6806 4" DEEP. VERIFIED WITH 2 REMAINING TIES. THIS CERTIFICATE IS BEING FILED TO UPDATE THE REFERENCE TIES.

SE CORNER

FND 5/8" REBAR, 8" DEEP

N=7214810.29 E=16653208.12 Z=1439.50

USED CERTIFICATE RECORDED ON AUGUST 29, 1995 BY PLS #8893 AND A METAL LOCATOR TO SEARCH AREA. COULD NOT LOCATE MONUMENT WITH METAL LOCATOR. USED PLAT RECORDED IN INSTRUMENT #96-1361 AND SECTION CORNER TIES TO CALC POINT, DUG AND FOUND A 5/8" REBAR 8" DEEP. PULLED AND SET NEW 5/8" REBAR TO HELP WITH MAGNETISM. THIS CERTIFICATE IS BEING FILED TO UPDATE THE CORNER CERTIFICATE.

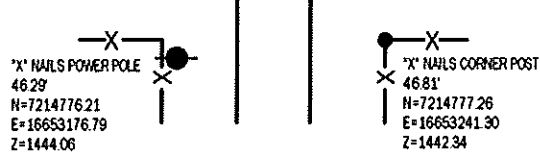
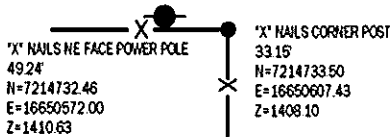
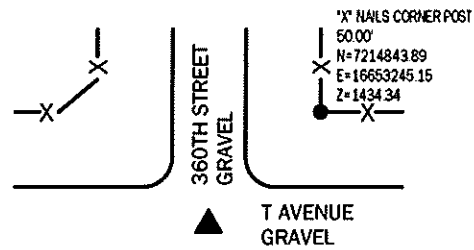
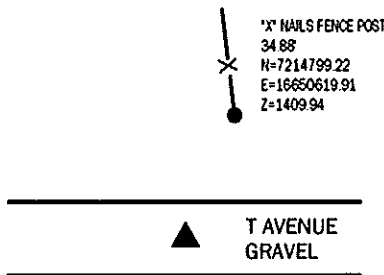

*All distances are measured horizontally unless noted.

I HEREBY CERTIFY THAT THIS LAND SURVEYING DOCUMENT WAS PREPARED BY ME OR UNDER MY DIRECT PERSONAL SUPERVISION AND THAT I AM A DULY LICENSED PROFESSIONAL LAND SURVEYOR UNDER THE LAWS OF THE STATE OF IOWA.

Mike Schulte
 MIKE SCHULTE
 LICENSE NUMBER: 17979
 LICENSE RENEWAL DATE IS DECEMBER 31, 2025
 PAGES COVERED BY THIS SEAL: 1 OF 1

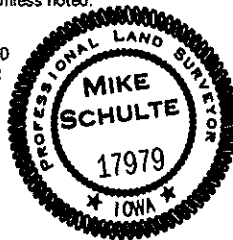

LIST CORNERS TO BE INDEXED

CORNER	SECTION	TWP	RANGE
S1/4 CORNER	5	82	37
N1/4 CORNER	8	82	37
SE CORNER	5	82	37
SW CORNER	4	82	37
NW CORNER	9	82	37
NE CORNER	8	82	37

BASIS OF BEARING

IA RCS ZONE 6 - US SURVEY FEET
 IARTN DERIVED - NAD83(2011)(EPOCH 2010.00)

SCHULTE SURVEYING, INC.

DRAWN BY: SLG
 PROJ NUMBER: 25-041