

2003 MAY 14 PM 12:41

INST. NO. 2003-1833
DENISE MEEVES, RECORDER
Denise Meeves
FFP 6.00

PREPARED BY: J. SCOTT SHEVEL L.S., KUEHL AND PAYER LTD., 423 WEST MAIN ST., SAC CITY, IA 50583 PH. (712)662-7859

**UNITED STATES PUBLIC LAND SURVEY CORNER CERTIFICATE
OF**

LAND SURVEY MONUMENTS SITUATED IN SECTION 12, TOWNSHIP 85 NORTH,
RANGE 37 WEST, OF THE 5TH PRINCIPAL MERIDIAN, CRAWFORD COUNTY, IOWA.

PREVIOUSLY RECORDED IN BOOK _____ PAGE _____

MONUMENT DESCRIPTION AND REMARKS:

- 1.) E 1/4 CORNER 12-85-37: FOUND PK NAIL IN PAINTED CENTERLINE OF COUNTY ROAD M-64
2.) SE CORNER 12-85-37: FOUND 3/4" BOLT 4" DEEP IN ASPHALT NEAR PAINTED CENTERLINES OF COUNTY ROADS E-16 & M-64

PLAN - VIEW

1.) E 1/4 CORNER
12-85-37
FD. PK NAIL IN PAINTED
CENTERLINE OF CO. RD. M-64

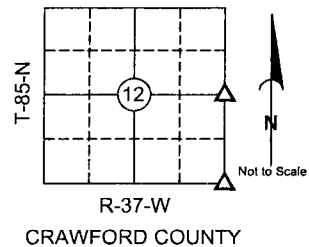
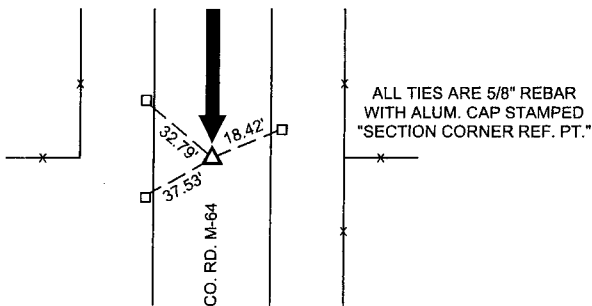

2.) SE CORNER
12-85-37
FD. 3/4" BOLT 4" DEEP IN
ASPHALT, NEAR PAINTED
CENTERLINES OF CO. RD.
E-16 & M-64

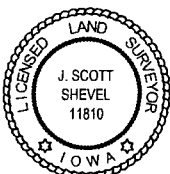
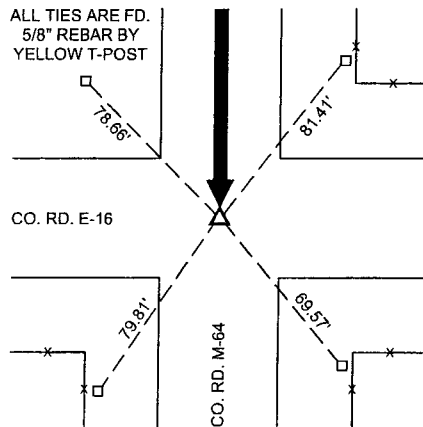

I hereby certify that this land surveying document was prepared and the related survey work was performed by me or under my direct personal supervision and that I am a duly licensed Land Surveyor under the laws of the State of Iowa.

J. Scott Shevel 5/12/03
Date: _____
J. Scott Shevel
License Number 11810
My license renewal date is December 31, 2003
Pages covered by this seal 1

List Corners to be Indexed

Corners	Section	Township	Range
1) E 1/4	12	85	37
2) SE	12	85	37