

INDEX \_\_\_\_\_  
SCAN \_\_\_\_\_  
FOLLOW UP \_\_\_\_\_  
PROOF \_\_\_\_\_

Instrument #: 2022-1174  
05/05/2022 01:10:10 PM Total Pages: 1  
PLC PLAT COR CERT  
Recording Fee: \$0.00 Transfer Tax: \$0  
Denise Meeves, Recorder, Crawford County Iowa

PREPARED BY: PAUL ASSMAN-CRAWFORD COUNTY ENGINEER'S OFFICE-COURTHOUSE-DENISON, IA.-712-263-2449

### UNITED STATES PUBLIC LAND SURVEY CORNER CERTIFICATE OF

LAND SURVEY MONUMENT SITUATED IN JACKSON TOWNSHIP, SOUTH 1/4 CORNER OF SECTION 8, T-85N,  
R-37W OF THE FIFTH P.M. CRAWFORD COUNTY, IOWA.

PREVIOUSLY RECORDED AS NO. 98-3642

#### MONUMENT DESCRIPTION AND REMARKS

SOUTH 1/4 CORNER SEC. 8-85-37

FOUND CHISELED "X"  
COUNTY RESURFACED ROAD AND SET 1/2" X 4" CARRIAGE  
BOLT 1/4" BELOW SURFACE AND RETIED

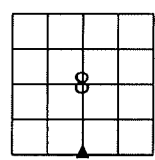

SOUTH 1/4 CORNER SEC. 8-85-37

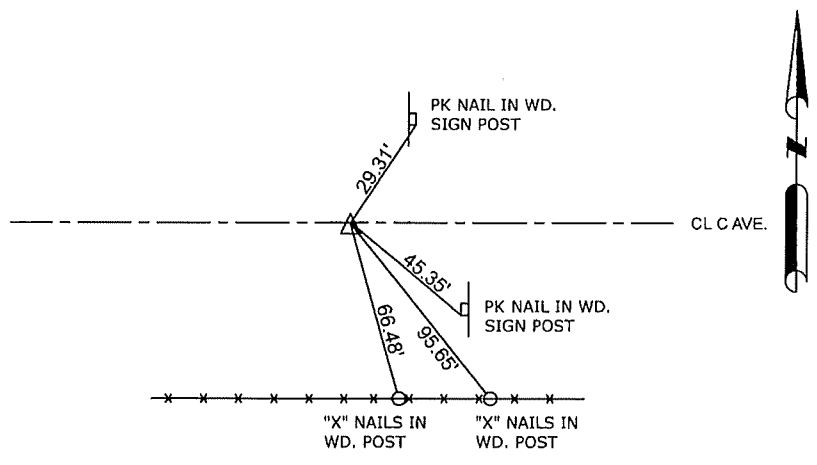

ALL TIE DISTANCES ARE MEASURED HORIZONTALLY USING GPS

#### CERTIFICATION:

I HEREBY CERTIFY THAT THIS LAND SURVEYING DOCUMENT WAS PREPARED AND THE RELATED SURVEY WORK WAS PERFORMED BY ME OR UNDER MY DIRECT PERSONAL SUPERVISION AND THAT I AM A DULY LICENSED LAND SURVEYOR UNDER THE LAWS OF THE STATE OF IOWA.

  
Signature

5/4/22  
Date of Survey

PAUL J. ASSMAN 11982  
Typed Name L.S. No.

12-31-22  
License Renewal Date

Pages covered by this seal 1

