

INDEXED DM/DM
 FOLLOW UP DM
 PROOFED DM
 SCANNED DM

Instrument #: 2016-1577
 07/28/2016 11:11:06 AM Total Pages: 1
 PLC PLAT CORNER CER
 Recording Fee: \$0.00 Transfer Tax: \$0
 Denise Meeves, Recorder, Crawford County Iowa



PREPARED BY: PAUL ASSMAN-CRAWFORD COUNTY ENGINEER'S OFFICE-COURTHOUSE-DENISON, IA.-712-263-2449

UNITED STATES PUBLIC LAND SURVEY CORNER CERTIFICATE OF

LAND SURVEY MONUMENT SITUATED IN JACKSON TOWNSHIP, THE EAST 1/4 CORNER OF SECTION 24, T-85N,
R-37W OF THE FIFTH P.M. CRAWFORD COUNTY, IOWA.

PREVIOUSLY RECORDED AS NO. 2006-2430

MONUMENT DESCRIPTION AND REMARKS

EAST 1/4 CORNER SEC. 24-85-37

FOUND 5/8" IRON ROD @ ASPEN AVE. FLUSH WITH TOP OF SLAB USING EXISTING TIES. COMPLETED HMA OVERLAY. SET CARRIAGE BOLT 0.05' DEEP OVER IRON ROD AND RETIED CORNER.

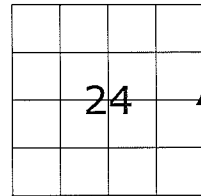

EAST 1/4 CORNER SEC. 24-85-37

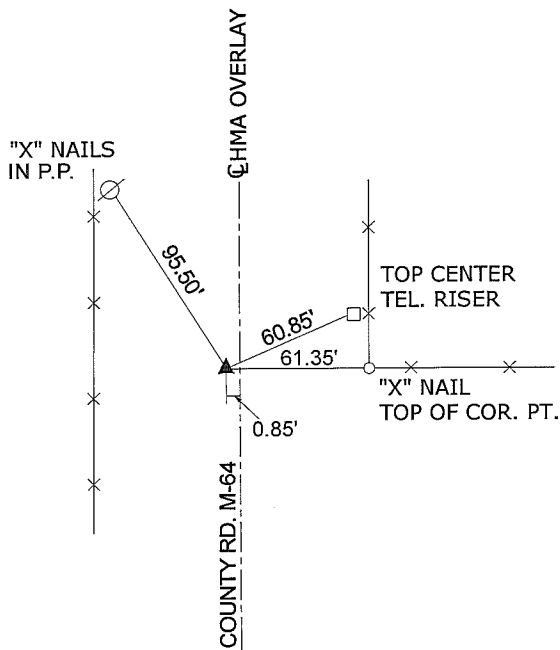

ALL DISTANCES ARE PLUMB CHAINED

CERTIFICATION:

I HEREBY CERTIFY THAT THIS LAND SURVEYING DOCUMENT WAS PREPARED AND THE RELATED SURVEY WORK WAS PERFORMED BY ME OR UNDER MY DIRECT PERSONAL SUPERVISION AND THAT I AM A DULY LICENSED LAND SURVEYOR UNDER THE LAWS OF THE STATE OF IOWA.

Paul J. Assman 7/27/16
 Signature Date of Survey

PAUL J. ASSMAN 11982 12-31-16
 Typed Name L.S. No. License Renewal Date

Pages covered by this seal 1

