

Sara Meseck, RECORDER
 Crawford County, Iowa
 Instr. Number: 2026-0741
 Recorded: 4/15/2026 at 10:59:11.0 AM
 Pages 1
 County Recording Fee: \$7.00
 Iowa E-Filing Fee: \$3.13
 Combined Fee: \$10.13
 Revenue Tax:

PREPARED BY AND RETURN TO: MIKE SCHULTE, SCHULTE SURVEYING, INC., 2003 390TH STREET, WESTSIDE, IA 51467 (712) 790-3489

UNITED STATES PUBLIC LAND SURVEY CORNER CERTIFICATE OF LAND SURVEY MONUMENTS SITUATED IN SECTION 26, TOWNSHIP 85 NORTH, RANGE 37 WEST, OF THE FIFTH PRINCIPAL MERIDIAN, CRAWFORD COUNTY, IOWA. PREVIOUSLY RECORDED IN SEE BELOW IN COUNTY RECORDER'S OFFICE.
(book, page instrument number)

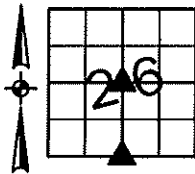

CENTER OF SECTION
 SET 5/8" REBAR YPC #17979

N=7291320.05 E=16666257.85 Z=1403.44
 NO CORNER CERTIFICATE FOUND. OLD RECORDS INDICATE OWNERSHIP DIFFERENCE. PROBED AREA AROUND CORNER POST, FOUND NOTHING. SET 5/8" REBAR YPC #17979 AT FENCE INTERSECTION.
 THIS CERTIFICATE IS BEING FILED DUE TO NONE OF RECORD.

S1/4 CORNER

FND 1/2" REBAR YPC #11804 5" DEEP
 N=7288687.54 E=16666283.55 Z=1392.36
 USED CERTIFICATE RECORDED IN FEE BOOK 2006-2433 AND A METAL LOCATOR TO FIND A 1/2" REBAR YPC #11804 5" DEEP. VERIFIED WITH 1 REMAINING TIE.
 THIS CERTIFICATE IS BEING FILED TO UPDATE THE REFERENCE TIES.

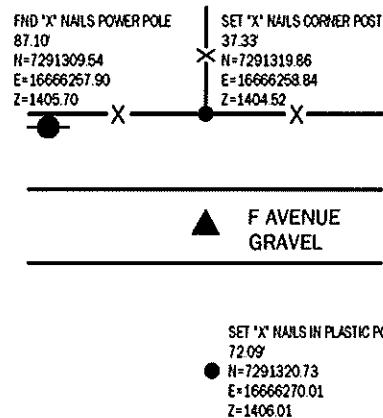
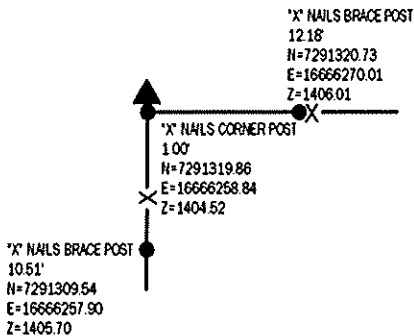

*All distances are measured horizontally unless noted.

I HEREBY CERTIFY THAT THIS LAND SURVEYING DOCUMENT WAS PREPARED BY ME OR UNDER MY DIRECT PERSONAL SUPERVISION AND THAT I AM A DULY LICENSED PROFESSIONAL LAND SURVEYOR UNDER THE LAWS OF THE STATE OF IOWA.

Mike Schulte
 MIKE SCHULTE
 LICENSE NUMBER: 17979
 LICENSE RENEWAL DATE IS DECEMBER 31, 2027
 PAGES COVERED BY THIS SEAL: 1 OF 1



LIST CORNERS TO BE INDEXED

CORNER	SECTION	TWP	RANGE
S1/4 CORNER	26	85	37
N1/4 CORNER	35	85	37
CENTER OF SECTION	26	85	37

BASIS OF BEARING

IA RCS ZONE 6 - US SURVEY FEET
 IA RTN DERIVED - IAD83(2011)(EPOCH 2010.00)

SCHULTE SURVEYING, INC.

DRAWN BY: SLG
 PROJ NUMBER: 26-039