

FILED DENISON, IOWA  
 CRAWFORD COUNTY  
 2000 MR 10 AM 10:04  
 INST. NO. 2000-0625  
 DENISE MEEVES, RECORDER  
*Denise Meeves*  
 FEE \$ 6.00

INDEXED  
 FOLLOW UP  
 PROCEED

PREPARED BY - TERENCE E. CRAWFORD - SUNDQUIST ENGINEERING - 120 S. MAIN, DENISON, IOWA 51442 - PHONE (712)263-8118

**UNITED STATES PUBLIC LAND SURVEY CORNER CERTIFICATE  
 OF**

LAND SURVEY MONUMENT SITUATED IN SECTION 32, T 85 N, R 37 W OF  
 THE 5TH P.M., CRAWFORD COUNTY, IOWA.  
 PREVIOUSLY RECORDED IN BOOK \_\_\_\_\_, PAGE \_\_\_\_\_, OTHER \_\_\_\_\_

**MONUMENT DESCRIPTION AND REMARKS**

W1/4 CORNER - FOUND LEAD PLUG IN PAVEMENT  
 SW CORNER - FOUND LEAD PLUG IN PAVEMENT

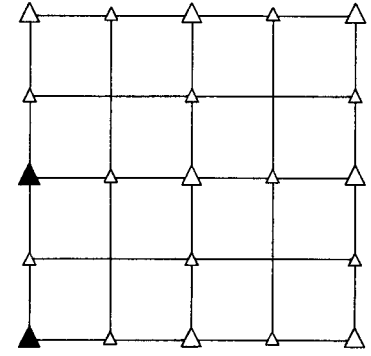

**PLAN VIEW SHOWING RELATIVE LOCATION OF MONUMENT AND REFERENCE POINTS.**

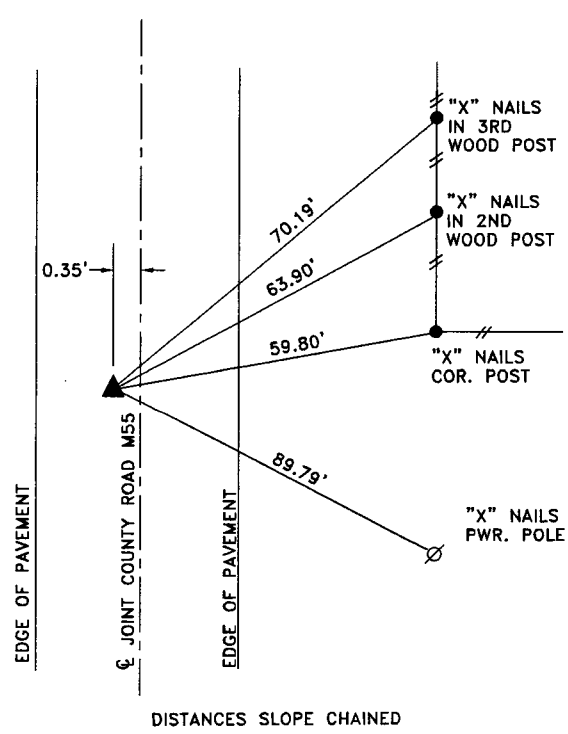

W1/4 CORNER SECTION 32-85-37

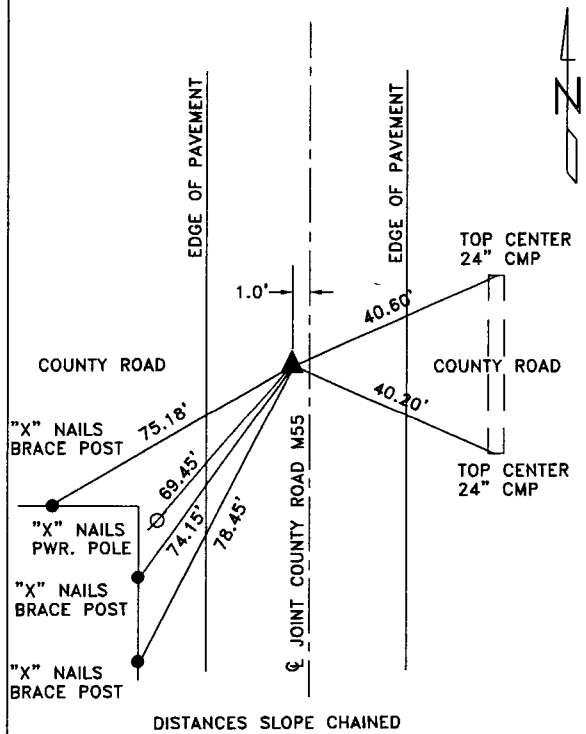

SW CORNER SECTION 32-85-37

I HEREBY CERTIFY THAT THIS LAND SURVEYING DOCUMENT WAS PREPARED AND THE RELATED SURVEY WORK WAS PERFORMED BY ME OR UNDER MY DIRECT SUPERVISION AND THAT I AM A DULY LICENSED LAND SURVEYOR UNDER THE LAWS OF THE STATE OF IOWA.

*Terence E. Crawford*  
 TERENCE E. CRAWFORD

IA LICENSE NO. 8893

FEB 29 2000

DATE

EXP. DATE DECEMBER 31, 2001

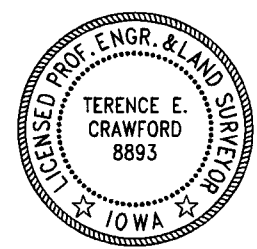

SE PROJECT NO. 21500