

COPY

Crawford County Recorder
 Denise Meeves
Fee Book 2008-2585
 09/12/2008 @11:11AM
 PLC PLAT CORNER CER
 Book: Page: # Pages: 2
 Total Fees: \$12.00

Lee O. Gallentine LS, Ryken Engineering, 511 Bank St., Webster City, IA 50595 - Ph. 515-832-1876 - Fax 515-832-1932

UNITED STATES PUBLIC LAND SURVEY CORNER CERTIFICATE

OF

Land Survey Monuments situated in Section **6**, Township **85** North, Range **37** West, of the Fifth Principal Meridian, Crawford County, Iowa, Previously recorded in (see below) in County Recorder's Office
 NE Cor. - Inst. #97-1823
 N $\frac{1}{4}$ Cor. - Not Applicable

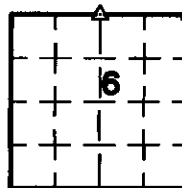

These corners were used for a survey in Section 31-86-37 in Sac County. Basis of bearing for this corner cert. can be found on the associated plat of survey filed in the Sac Co. Rec's Office.

Legend

- | | | |
|--------------------------------------|--|------------------------------------|
| BC = Nail with Bottle Cap | ID = Inside Diameter | R/W = Iron ROW Nail |
| BP = Brace Post | OD = Outside Diameter | SFP = Steel 'T' Post |
| CP = Corner Post | PP = Power Pole | SW = Nail with Square Metal Washer |
| CMP = Corrugated Metal Pipe | PW = Nail with Plastic Washer | TP = Telephone Pedestal |
| CM = 4" Sq Concrete Monument with | RCP = Reinforced Concrete Pipe | TW = Nail with Round Metal Washer |
| 1/2" Iron rod in center (tie to rod) | RH = Red Head (Nail in wire) | WFP = Wood Fence Post |
| CX = Cut 'X' | ROW = Right of Way | X = X Nails |
| GP = Gate Post | RW = Nail with Reflective Round Washer | |



N $\frac{1}{4}$ Cor.

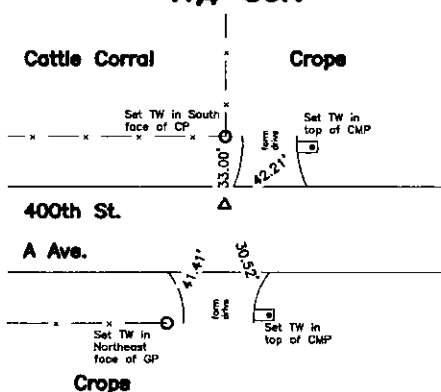

SAC CO ENGR'S RECORD TIES

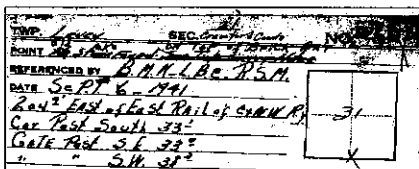

CRAWFORD CO ENGR'S RECORD TIES

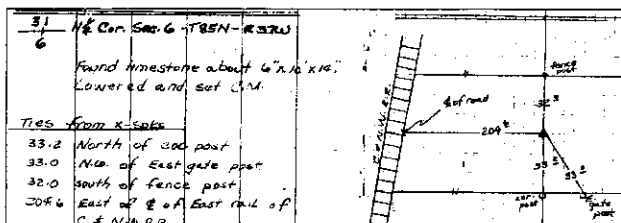

Monument Description, Remarks, and Plan View:

N $\frac{1}{4}$ Cor. History of Corner =
 Sac County current Co Engr's ties indicate that corner is monumented with 'old lake stone Found on Top of Brick Bat' with ties as shown above.
 Crawford County current Co Engr's ties indicate that corner is monumented with 'Found limestone about 6" x 10" x 14". Lowered and set C.M.' with ties as shown above.

Corner Recovery =
 Excavated 4.5'± (North-South) x 2.5'± (East-West) x 2.0'± deep hole around point at 33.0' South of corner post and in-line with fence North and found nothing. Searched hole to 5.0' deep with tile probe and found nothing. Excavated North half of hole to 4.0' deep, probed to 6.0' deep, and found nothing. Since no monumentation could be located and since the railroad track to the West has been removed, the only remaining evidence of the corner location is fencelines in the area. Therefore, set $\frac{3}{4}$ " x 4.0' alum capped iron rerod (#15745) stamped 'N $\frac{1}{4}$ COR', '6', and '31' in-line with the fenceline North at 33.0' South of existing corner post, and used it as the correct corner. Rerod is 0.5' deep at 7.0'± North of apparent centerline of traveled surface of dirt road East-West and in-line with fence North. All ties are plumb distance unless indicated otherwise.

This certificate is being prepared because there are no certificates on file for this corner.

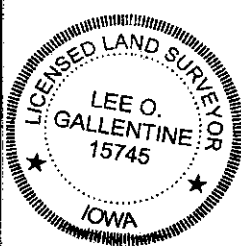

I hereby certify that this land surveying document was prepared and the related survey work was performed by me or under my direct personal supervision and that I am a duly licensed Land Surveyor under the laws of the State of Iowa.
 LEE O. GALLENTINE, LS
 Date: Aug 11 2008 license number: 15745
 My license renewal date is December 31, 2008
 Pages or sheets covered by this seal: 1 & 2

List Corners to be Indexed

Corners	Section	Twp	Range
N $\frac{1}{4}$ Cor.	6	T85N	R37W
NE Cor.	6	T85N	R37W

Pg 1 of 2
 P:\BOB\SACCO\S318637\PRESTAGE4640\dwg\4640Ccorner.dwg