

16/15
2-1/22

Resurvey 6-10-40 Day 4 X5 X10' holes
 center intersection no find
 Checked dist from 1/4 CM W to
 Sec C on E and Fe line South
 agrees. Checked center intersection
 North to CM in gravel Rd
 1/4 x 1/4 Fe close
 Set CM at temp point

Ties

446 SE from pipe in top of Lane Corner
 53.0 S SW from black dust tree
 442 SW from car post to school yard
 106.3 SW from Pump School Yard
 34.0 North from ga to post Fe South
 39.7 NW from 28" cottonwood stump
 37.2 NE " " W get post

Found 4/23/46
 3.0' Deep Wgn,

29-42 E

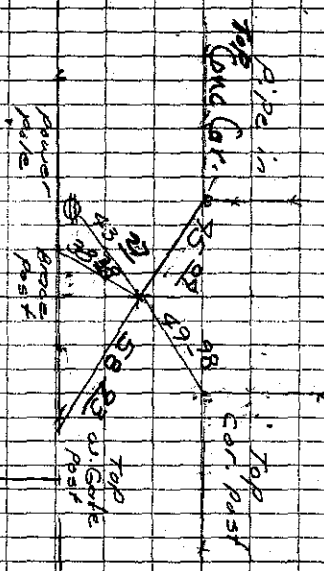

Established 10-16-40
 Chapin 3 Wires
 3 boundary line

Found Cor. 9.0' deep
 5-25-73
 Cur - 6" diameter 100' cross
 1/8" iron bolt over center
 12" deep
 6718-03
 Found 1/2" IRON BOLT 35"
 DEEP SET 1" REBAR
 OVER 17 8" DEEP
 BENDT

3.1