

22-23

4-13-40 Dog 2 1/2 X 16 X 127 in line of
E & W fences no find

2
to dog

15
22

4-13-40 Dog 2 1/2 X 16 X 127 in line of NCS
1/4 fence NCS slightly off line but
about 4 between Sec Corners

Rd fence & within 2' of Sec Cor
line fence CPN Set on line
of Sec Corners from 1/4 fence S. Along

- Ties to posts
- 30.8 N from E lane car post
- 39.0 NE from W lane cor post
- 32.9 South of cor post Fe North
- 73.8 SW from 5th post E of Cor.

24-17

24-21 E

Established 10-16-40

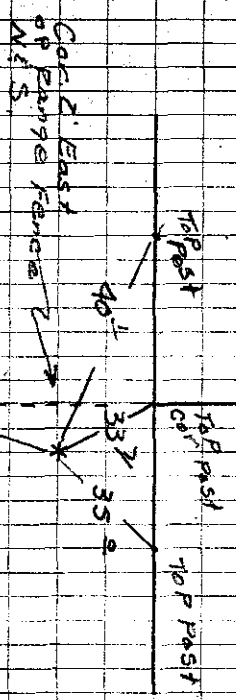

Car was at surface
broke off Top 1/4 foot
of 1/4 and relevel. BY
LEARNERS - (BERRY)

10-9-25

1932