

20/21
29/28

6-10-40 Dug 81x61x9 hole

Found 1 post 5x6x10² knock 2nd x 4th 6th
at a depth of 10". Lowered and set
C.M.

26.2	E	from 3 rd post W
10.5	S	" " 2 nd post N
19.0	W	" " 3 rd post E
25.8	N	" " 3 rd " S
COL 15 2.5	W	from cor post

29/29

N

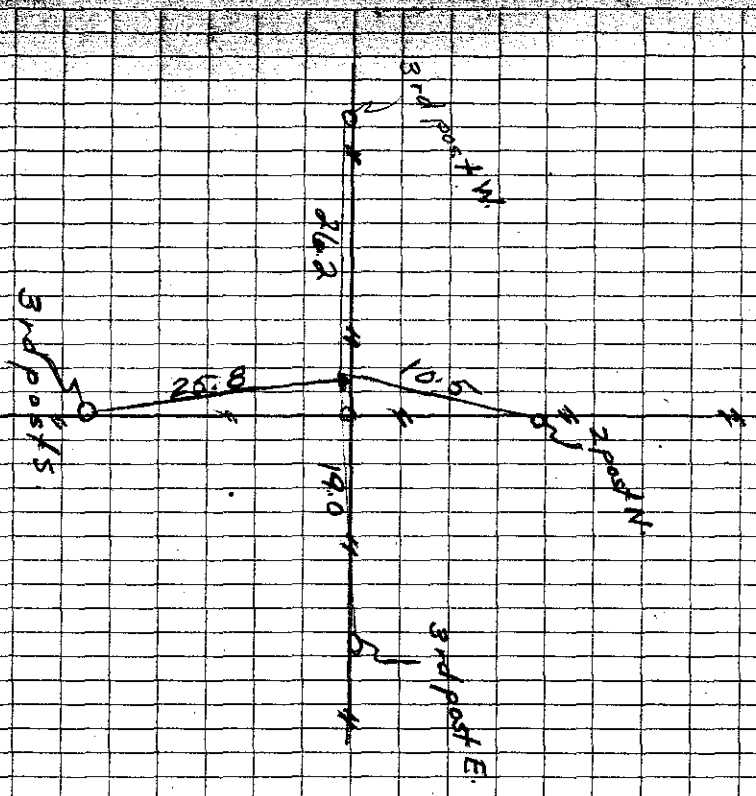

Found S-27-41
NE NE E - 50x100

57