

34135

9-20-39 Bug. 5'x16'x20' hole line  
of fences E & W. 5' cut at this point

Chaired out from both corners  
doubled 1/4 1/4 corners set points  
split d. 4 corners set point hook  
Q of road & set point. Split  
difference in two points &  
set stake

27 9-28-39 Dug - 24'x4'x20' hole in  
34. line of N & S fence. No find

Cor. well deep. Jim North, Kri. Iowa says  
Cor. was destroyed. Split 60' road  
and set on N & S fence. This checks  
with ransom Channing & least evidence  
has from x-spks.

29.9 N of cor post  
55.4 NE of 20" w o l n r t  
25.4 S of cor post  
28.7 SW of power pole

16-38.5

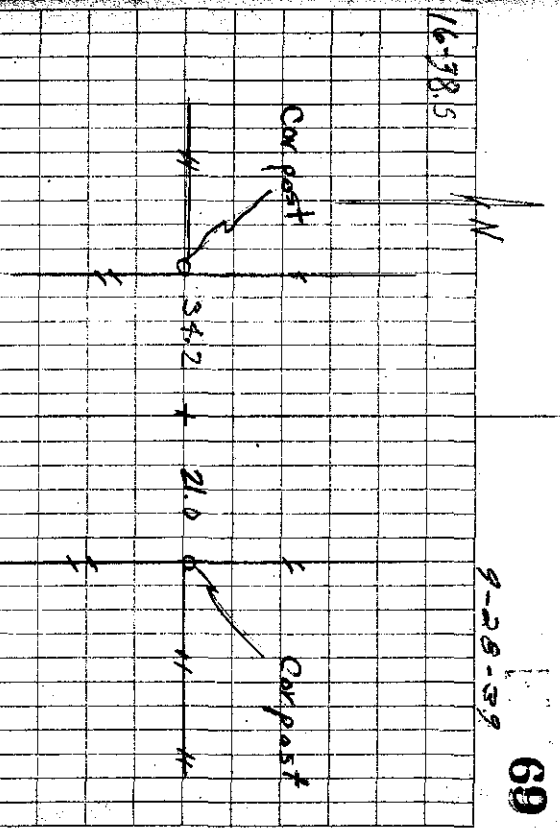

9-28-39

69

16-35 S

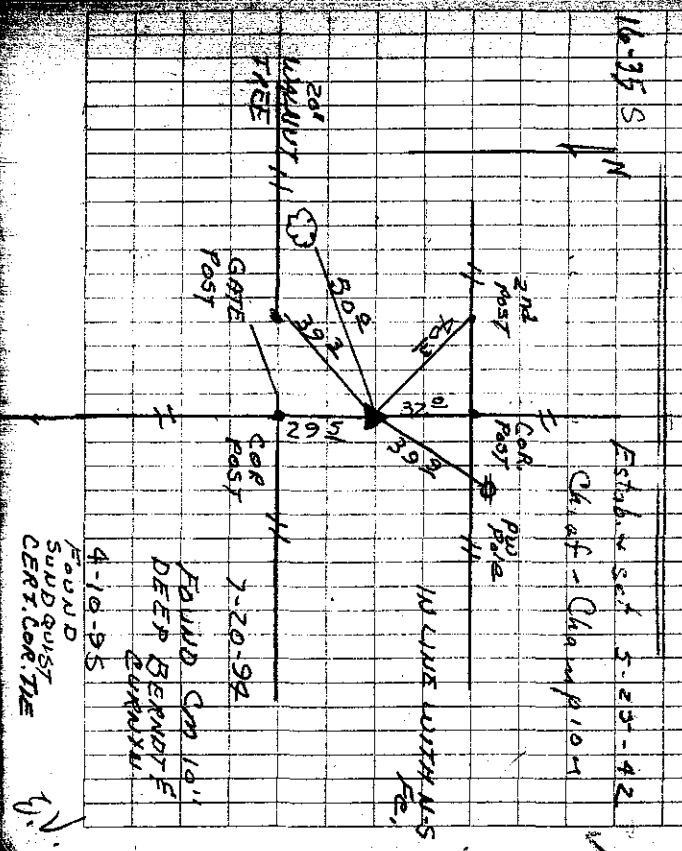

FOUND  
SUNDQUIST  
CERT. COR 11-12

11-12