

✓ 2004 JAN 20 PM 1:59  
INST. NO. 2004-0155  
DENISE MEYER, RECORDER  
*Denise Meyer*  
FEE \$ 11.00

George A. Parris, PE/LS, JEO Consulting Group, Inc., 724 Simon Avenue, Carroll, Iowa 51401, 712-792-9711

UNITED STATES PUBLIC LAND SURVEY  
CORNER CERTIFICATE  
Land Survey Monument Situated in Section 36  
Township 84 North Range 38 West, of the 5th P.M.  
CRAWFORD County, Iowa.

Monument Description and Remarks:

Found 1 inch rebar located centerline of gravel road, 20 inches deep. Brought corner up to 3 inches deep with 1/2 inch iron pin, cap number 12108.

PLAN - VIEW  
WEST QUARTER CORNER  
SECTION 36 - T 84 N - R 38 W

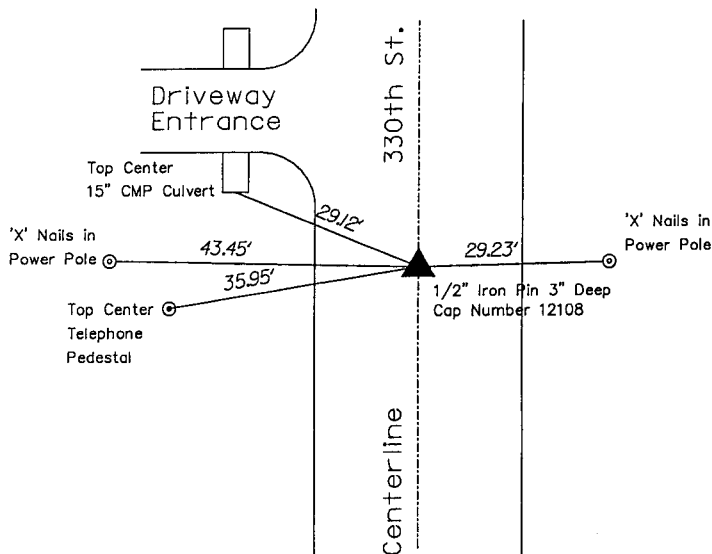

NO SCALE

All ties are " X " nails unless noted otherwise

1227SU20

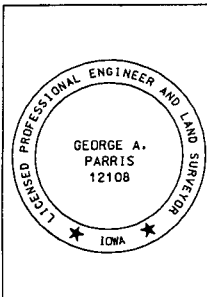

I hereby certify that this land surveying document was prepared and the related survey work was performed by me or under my direct personal supervision and that I am a duly licensed Land Surveyor under the laws of the State of Iowa.

*George A. Parris* 1-7-04  
George A. Parris Date  
My license renewal date is December 31, 2004

Sheets covered by this seal:  
ALL

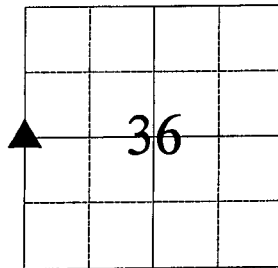

List Corner to be Indexed  
Corner Section Twp Range  
W1/4 36 84 38

**JEO**  
Consulting  
Group, Inc.

712792-8711  
724 SIMON AVENUE  
CARROLL, IOWA  
51401

CORPORATE OFFICE  
40294-4881  
P.O. BOX 227  
WAVY, NE  
68083

BRANCH OFFICES  
IOWA CITY, IA  
318238-3828

LINCOLN, NE  
40206-2002

HARTSEL, NE  
40268-0857

NONPOLK, NE  
40257-8418

NEBRASKA CITY, NE  
40257-4786  
NEW RICHMOND, WI  
712266-4318  
<http://www.jeo.com>