

2004 JAN 20 PM 2:08

INST. NO. 2004-0163

DENSE MEYER, RECORDER

*Dense Meyer*  
FEE # 1100

George A. Parris, PE/LS, JEO Consulting Group, Inc., 724 Simon Avenue, Carroll, Iowa 51401, 712-792-9711

UNITED STATES PUBLIC LAND SURVEY  
CORNER CERTIFICATE  
Land Survey Monument Situated in Section 36  
Township 84 North Range 38 West, of the 5th P.M.  
CRAWFORD County, Iowa.

Monument Description and Remarks:

Set P.K. nail in asphalt paving east bound lane of U.S. Hwy 30 5.5' RT of centerline,  
on line split between N1/4 and Center of Section.

PLAN - VIEW  
SW CORNER of the NW1/4 of the NE1/4  
SECTION 36 - T 84 N - R 38 W

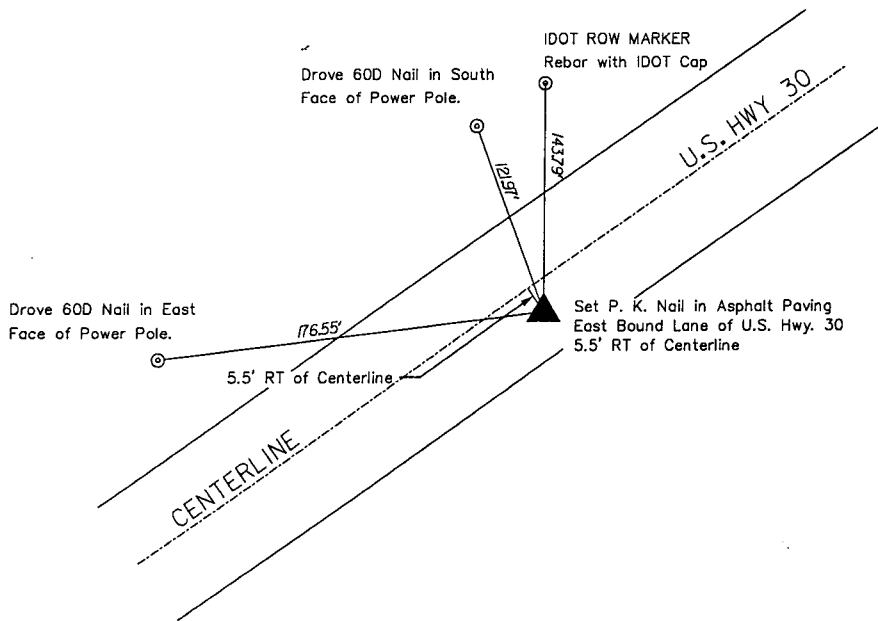

NO SCALE

All ties are " X " nails unless noted otherwise

1227SU20

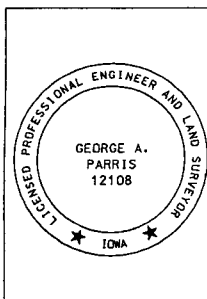

I hereby certify that this land surveying document was prepared and the related survey work was performed by me or under my direct personal supervision and that I am a duly licensed Land Surveyor under the laws of the State of Iowa.  
*George A. Parris* 1-7-04  
George A. Parris Date  
My license renewal date is December 31, 2004  
Sheets covered by this seal:  
ALL

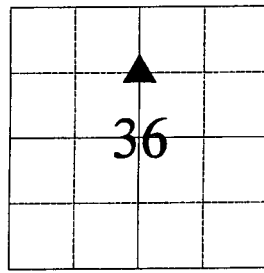

List Corner to be Indexed  
Corner Section Twp Range  
SW-NW1/4- 36 84 38  
NE1/4

**JEO**  
Consulting  
Group, Inc.  
712/792-8711  
724 SIMON AVENUE  
CARROLL, IOWA  
51401  
CORPORATE OFFICE  
40845-4881  
P.O. BOX 207  
HAWCO, NE  
68328  
BRANCH OFFICES  
IOWA CITY, IA  
319/388-3838  
LINCOLN, NE  
402/448-3040  
HATTYSBURG, NE  
402/645-8527  
HORNOLA, NE  
402/271-9476  
NEBRASKA CITY, NE  
402/873-8700  
NEW HAMBURG, NY  
716/668-0219  
<http://www.jeo.com>