

INDEXED
 FOLLOW UP
 PROOFED
 SCANNED

Crawford County Recorder
 Denise Meeves
Fee Book 2009-2667
 10/13/2009 @11:50AM
 PLC PLAT CORNER CER
 Book: Page: # Pages: 1
 Total Fees: \$0.00

PREPARED BY: MICKAEL F. BERNDT - CRAWFORD COUNTY ENGINEER'S OFFICE - COURTHOUSE - DENISON, IA. - 712-263-2449

UNITED STATES PUBLIC LAND SURVEY CORNER CERTIFICATE
OF

LAND SURVEY MONUMENT SITUATED IN MILFORD TOWNSHIP, THE CENTER
 OF SECTION 5, T-84N, R-38W OF THE FIFTH P.M. CRAWFORD COUNTY, IOWA.

PREVIOUSLY RECORDED AS NO.

MONUMENT DESCRIPTION AND REMARKS

CENTER SEC. 5-84-38
 DATE SET: 10-06-09

SUNDQUIST ENGINEERING HAD ESTABLISHED CORNERS IN THIS AREA FOR A SURVEY OF THE BOYER RIVER. USING SOME OF THEIR DATA WHICH IS ON FILE AT THE COUNTY ENGINEER'S OFFICE. THE CORNER WAS SET ON A LINE PROJECTED BETWEEN THE N1/4 AND THE S1/4 SECTION CORNERS AND A PRORATED DISTANCE FROM THE N1/4 COR. A 5/8" X 14" REBAR WITH A YELLOW CAP #14808 WAS SET 10" DEEP AND TIED OFF.

CENTER SEC. 5-84-38

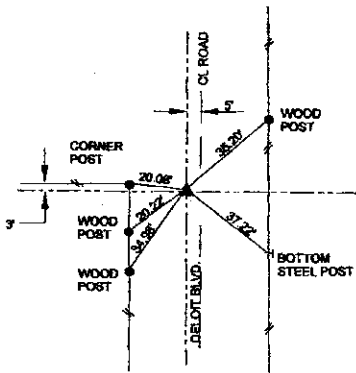

ALL DISTANCES ARE SLOPED CHAINED
 ALL TIES ARE "X" NAILS UNLESS NOTED.

CORNER: CENTER
 SECTION: 5
 TOWNSHIP: 84N
 RANGE: 38W

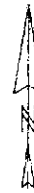
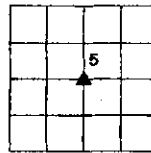

CERTIFICATION:

I HEREBY CERTIFY THAT THIS LAND SURVEYING DOCUMENT WAS PREPARED AND THE RELATED SURVEY WORK WAS PERFORMED BY ME OR UNDER MY DIRECT PERSONAL SUPERVISION AND THAT I AM A DULY LICENSED LAND SURVEYOR UNDER THE LAWS OF THE STATE OF IOWA.

Mickael F. Berndt
 Signature

10-2-09
 Date of Survey

MICKAEL F. BERNDT
 Typed Name

14808
 L.S. No.

Dec. 31, 2010
 License Renewal Date

Pages covered by this seal 1

