

COPY

Crawford County Recorder
Denise Meeves
Fee Book 2009-0294

02/06/2009 @01:12PM
PLC PLAT CORNER CER # Pages: 1
Book: Page: \$7.00
Total Fees:

INDEXED BM
FOLLOW UP _____
PROOFED _____
SCANNED _____

PREPARED BY: JOHN A. MUNSON III - SUNDQUIST ENGINEERING - 910 SEVENTH STREET, ONAWA, IOWA 51040-PHONE (712)423-3131

UNITED STATES PUBLIC LAND SURVEY CORNER CERTIFICATE OF
LAND SURVEY MONUMENT SITUATED IN SECTION 15, TOWNSHIP 85 NORTH, RANGE 40 WEST
OF THE FIFTH PRINCIPAL MERIDIAN, CRAWFORD, COUNTY, IOWA.
PREVIOUSLY RECORDED IN _____ IN COUNTY RECORDERS OFFICE.

MONUMENT DESCRIPTION AND REMARKS

NORTHEAST CORNER OF THE SOUTHEAST QUARTER OF THE SOUTHEAST QUARTER SECTION 15-85-40

SET 5/8" X 18" REBAR WITH RED CAP #11118. TOP OF REBAR 0.20' DEEP.

REBAR SET 1/2 WAY AND ONLINE BETWEEN E1/4 AND SE CORNER OF SECTION 15.

REBAR FITS CENTERLINE OF NORTH/SOUTH GRAVEL ROAD.

L. STUKENHOLTZ & R. ANDERSON

DATE 01-26-09

PLAN VIEW

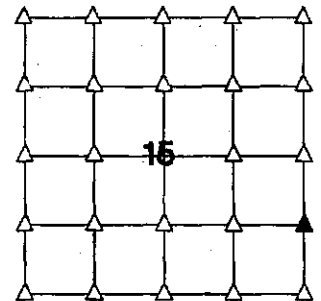
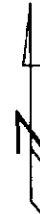
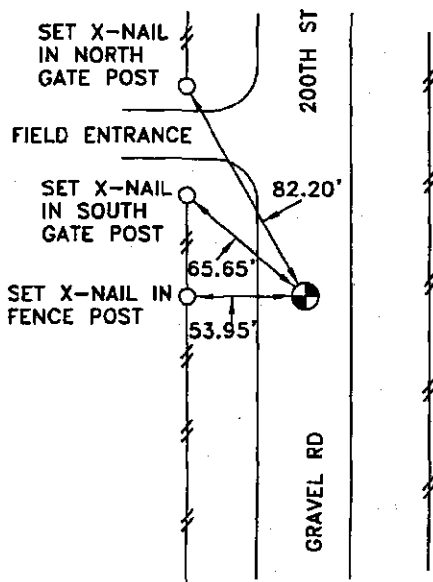

15-85-40

I HEREBY CERTIFY THAT THIS LAND SURVEYING DOCUMENT AND THE RELATED SURVEY WORK WAS PERFORMED BY ME OR UNDER MY DIRECT PERSONAL SUPERVISION AND THAT I AM A DULY LICENSED LAND SURVEYOR UNDER THE LAWS OF THE STATE OF IOWA.

John A. Munson III 2-4-09
JOHN A. MUNSON III DATE

IA. LICENSE NO. 11118 EXP. DATE DECEMBER 31, 2010

SE PROJECT NO. 30809T3 DRAWN BY: CSL

