

Denise Meeves RECORDER  
 Crawford County, Iowa  
 Instr. Number: 2019-0095  
 Recorded: 1/16/2019 at 12:00:29.0 PM  
 Pages 1  
 County Recording Fee: \$7.00  
 Iowa E-Filing Fee: \$3.13  
 Combined Fee: \$10.13  
 Revenue Tax:

PREPARED BY AND RETURN TO: MIKE SCHULTE, SCHULTE SURVEYING, INC., 2003 390TH STREET, WESTSIDE, IA 51467 (712) 790-3489

**UNITED STATES PUBLIC LAND SURVEY CORNER CERTIFICATE OF**

LAND SURVEY MONUMENTS SITUATED IN SECTION 07, TOWNSHIP 85 NORTH, RANGE 40 WEST, OF THE FIFTH PRINCIPAL MERIDIAN, CRAWFORD COUNTY, IOWA. PREVIOUSLY RECORDED IN SEE BELOW IN COUNTY RECORDER'S OFFICE.  
(book, page instrument number)

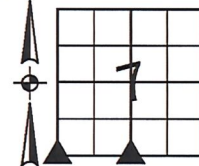

**SW CORNER**  
 FND 5/8" REBAR  
 NORTHING 7304064.53 EASTING 16548244.69 ELEV. 1345.5

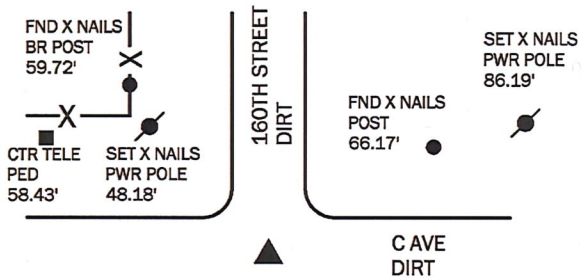

USED TIES RECORDED FB 2012-0075 TO FIND A BENT 5/8" REBAR AT SURFACE. SPUN, PULLED, AND STRAIGHTED THE COATED 5/8 REBAR AND SET IN THE SAME HOLE 4" DEEP. RETIENG THE CORNER BECAUSE X NAILS WERE SET ON TIE STRUCTURES RATHER THAN THE PREVIOUSLY USED CENTER OF STRUCTURES. I DO NOT EXPECT THE 5/8" REBAR TO LAST ANOTHER 10 YEARS DUE TO EROSION.

**S1/4 CORNER**  
 FND 1" REBAR 8" DEEP  
 NORTHING 7304096.04 EASTING 16550594.63

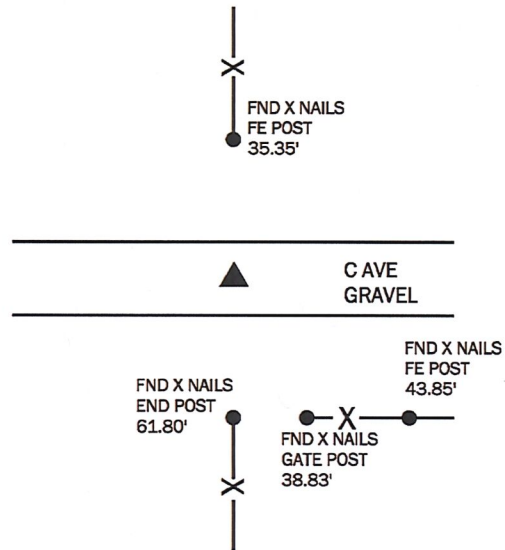

USED TIES RECORDED INST 96-1264 TO FIND 1" REBAR 8" DEEP. RETIED CORNER SINCE THE DEPTH HAS CHANGED AND TO VERIFY POSITION OF CORNER.

I HEREBY CERTIFY THAT THIS LAND SURVEYING DOCUMENT WAS PREPARED BY ME OR UNDER MY DIRECT PERSONAL SUPERVISION AND THAT I AM A DULY LICENSED PROFESSIONAL LAND SURVEYOR UNDER THE LAWS OF THE STATE OF IOWA.

*Mike Schulte*  
 MIKE SCHULTE DATE 2019/01/16  
 LICENSE NUMBER: 17979  
 LICENSE RENEWAL DATE IS DECEMBER 31, 2019  
 PAGES COVERED BY THIS SEAL: 1 OF 1



\*All distances are measured horizontally unless noted.

**LIST CORNERS TO BE INDEXED**

CORNER	SECTION	TWP	RANGE
S1/4 COR	7	85	40
N1/4 COR	18	85	40
SW COR	7	85	40
NW COR	18	85	40
SE COR	12	85	41
NE COR	13	85	41

**BASIS OF BEARING**

laRCS ZONE 6 - US SURVEY FEET  
 laRTN DERIVED - NAD83(2011)(EPOCH 2010.00)

**SCHULTE SURVEYING, INC.**

DRAWN BY: MLS  
 PROJ NUMBER: 19-001