

INDEXED \_\_\_\_\_  
 FOLLOW UP \_\_\_\_\_  
 PROOFED \_\_\_\_\_  
 SCANNED \_\_\_\_\_

Instrument #: 2018-1913  
 09/18/2018 01:51:26 PM Total Pages: 1  
 PLC PLAT CORNER CER  
 Recording Fee: \$0.00 Transfer Tax: \$0  
 Denise Meeves, Recorder, Crawford County Iowa



PREPARED BY: PAUL ASSMAN-CRAWFORD COUNTY ENGINEER'S OFFICE-COURTHOUSE-DENISON, IA.-712-263-2449

## UNITED STATES PUBLIC LAND SURVEY CORNER CERTIFICATE OF

LAND SURVEY MONUMENT SITUATED IN MORGAN TOWNSHIP, THE NORTH 1/4 CORNER OF SECTION 33, T-85N,  
R-40W OF THE FIFTH P.M. CRAWFORD COUNTY, IOWA.

PREVIOUSLY RECORDED IN MORGAN(2) TWP. FIELD BOOK ON PAGE 99 IN ENGINEER'S OFFICE

### MONUMENT DESCRIPTION AND REMARKS

NORTH 1/4 CORNER SEC. 33-85-40

SEARCHED FOR CORNER USING PREVIOUS ENGINEERING NOTES, BUT DID NOT FIND. COUNTY GRADED ROAD, PROJECT NO. LG50-27W. SET 5/8" REBAR WITH RED CAP #11982 1.5 FT. DEEP USING EXISTING ENGINEERING TIES AND FENCE LINES TO ESTABLISH CORNER. RETIED CORNER.

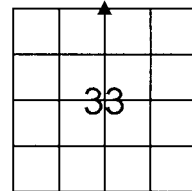

NORTH 1/4 CORNER SEC. 33-85-40

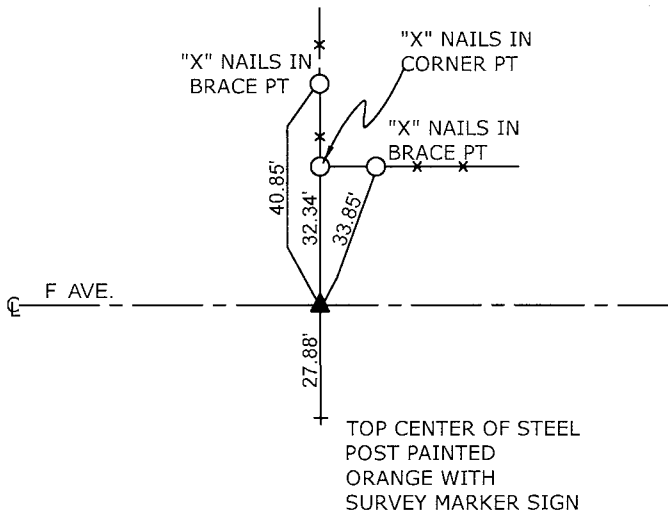

ALL DISTANCES ARE SLOPE CHAINED

**CERTIFICATION:**

I HEREBY CERTIFY THAT THIS LAND SURVEYING DOCUMENT WAS PREPARED AND THE RELATED SURVEY WORK WAS PERFORMED BY ME OR UNDER MY DIRECT PERSONAL SUPERVISION AND THAT I AM A DULY LICENSED LAND SURVEYOR UNDER THE LAWS OF THE STATE OF IOWA.

 Signature	7/31/18 Date of Survey
PAUL J. ASSMAN <small>Typed Name</small>	11982 <small>L.S. No.</small>
12-31-18 <small>License Renewal Date</small>	
Pages covered by this seal <u>1</u>	

