

INDEXED DM/bm  
 FOLLOW UP g  
 PROOFED g  
 SCANNED g

PREPARED BY: MICKAEL F. BERNDT - CRAWFORD COUNTY ENGINEER'S OFFICE - COURTHOUSE - DENISON, IA. - 712-263-2449

**UNITED STATES PUBLIC LAND SURVEY CORNER CERTIFICATE  
 OF**

**LAND SURVEY MONUMENT SITUATED IN NISHNABOTNA TOWNSHIP, THE NW CORNER  
 OF SECTION 13, T-82N, R-38W OF THE FIFTH P.M. CRAWFORD COUNTY, IOWA.**

PREVIOUSLY RECORDED AS

**MONUMENT DESCRIPTION AND REMARKS**

NW COR. OF SEC. 13-82-38

6-17-09 FOUND 3/4" STEEL BOLT AT THE SURFACE OF EXISTING ASPHALT PAVING. EXISTING PAVEMENT TO BE REMOVED AND REPLACED WITH PCC PAVEMENT. THE CORNER WAS TIED OFF.

11-19-09 A 5/8" DIA. X 4" CARRIAGE BOLT WAS SET TO THE SURFACE USING EXISTING TIES.

NW COR. OF SEC. 13-82-38

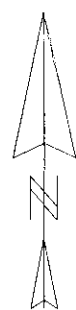
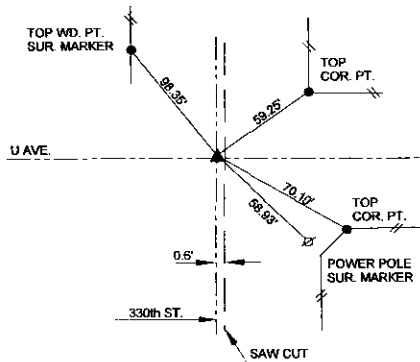

ALL DISTANCES ARE SLOPED CHAINED  
 ALL TIES ARE "X" NAILS UNLESS NOTED.

CORNER: NW COR.  
 SECTION: 13  
 TOWNSHIP: 82N  
 RANGE: 38W

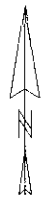
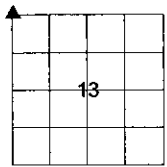

**CERTIFICATION:**

I HEREBY CERTIFY THAT THIS LAND SURVEYING DOCUMENT WAS PREPARED AND THE RELATED SURVEY WORK WAS PERFORMED BY ME OR UNDER MY DIRECT PERSONAL SUPERVISION AND THAT I AM A DULY LICENSED LAND SURVEYOR UNDER THE LAWS OF THE STATE OF IOWA.

Michael F. Berndt 2/9/2010  
 Signature Date of Survey

MICKAEL F. BERNDT 14808 Dec. 31, 2010  
 Typed Name L.S. No. License Renewal Date

Pages covered by this seal 1

