

Resurveyed 4-19-90
Notes R. S. Jamerson

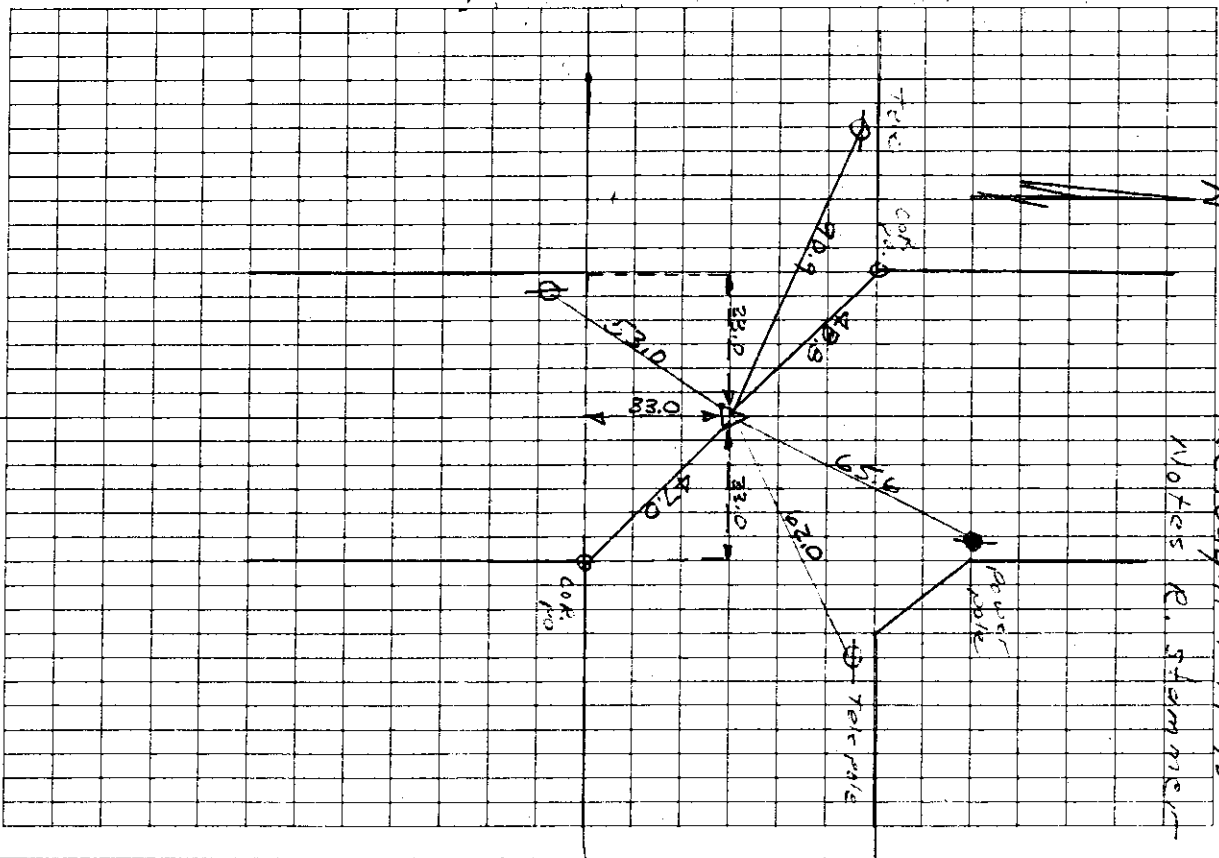

34 | 35 | SE COR. of Sec. 34-82-38

3 | 2 | Dug 2'x8'x3' hole in center of

Intersection. Did not find corner
Cut from 6' to 10' at this corner

See BKT # 11 old COR. Record

Lat. hub 60' spike
Ties from X-sprks

BK 29 p. 57

Original Mon. is
believed to have
been cut out
1983
Capped mon in 15' deep

11-05-03

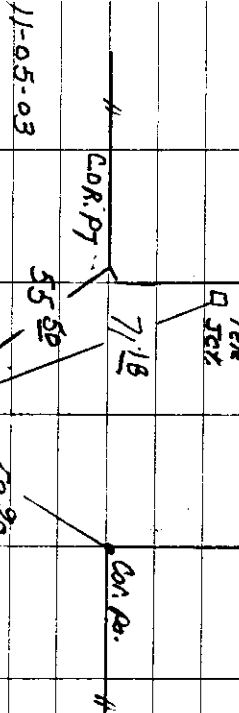

FOUND CAPPED PILE
18" DEEP SET

SPIKE OVERLIT

BERNDT