

WILKE LAND SURVEYING INC. 401 1800th Street Panama, Iowa 51562 (712)489-2898

## UNITED STATES PUBLIC LAND SURVEY CORNER CERTIFICATE

SECTION 20 TOWNSHIP 85N RANGE 39W COUNTY CRAWFORD

Reason for Certificate: (No record Certificate)

Monument Description and Remarks:

CENTER - No record for this corner was found at the County Engineer's Office. No evidence of ties or a monument was found on site. Calc'd an intersection point of lines connecting opposite 1/4 Corners to compare to the fence intersection point, with fences North, East, & West. Set 5/8" dia. by 24" rebar with orange cap PLS #17048 (0.4' deep) at the projected intersection of fences as the best evidence of the Center of the Section.

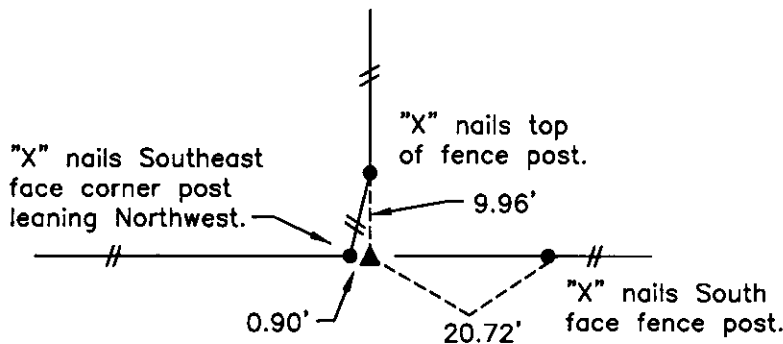
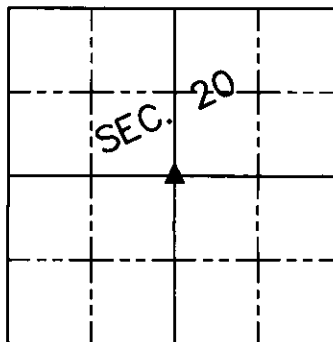

\*(All distances are plumb)

SET 5/8" DIA. REBAR W/ORANGE CAP PLS #17048 (0.4' DEEP).

	I hereby certify that this land surveying document was prepared and the related survey work was performed by me or under my direct personal supervision and that I am a duly licensed Land Surveyor under the laws of the State of Iowa.
	<p><i>Dean A. Wilke</i> 11/17/11          Dean A. Wilke Date</p> <p>License number 17048</p> <p>My license renewal date is December 31, 2011</p> <p>Pages or sheets covered by this seal: This page only</p>

List Corners to be Indexed			
Corner	Section	Twp.	Range
CENTER	20	85N	39W