

COPY

Crawford County Recorder
Denise Meeves
Fee Book 2009-2227

INDEXED ING
FOLLOW UP NG
PROOFED _____
SCANNED _____

08/20/2009 2:02:49PM
PLC PLAT CORNER CER
Book: _____ Page: _____ # Pages: 1
Total Fees: \$9.00

PREPARED BY - TERENCE E. CRAWFORD - SUNDQUIST ENGINEERING - 120 S. MAIN, DENISON, IOWA 51442 - PHONE (712) 263-8118

UNITED STATES PUBLIC LAND SURVEY CORNER CERTIFICATE
OF

LAND SURVEY MONUMENT SITUATED IN SECTION 23, T 85 N, R 39 W OF
THE 5TH P.M., CRAWFORD COUNTY, IOWA.
PREVIOUSLY RECORDED IN BOOK _____, PAGE _____, OTHER 2001-3433

MONUMENT DESCRIPTION AND REMARKS

S1/4 CORNER - FOUND BROKEN CM FLUSH.

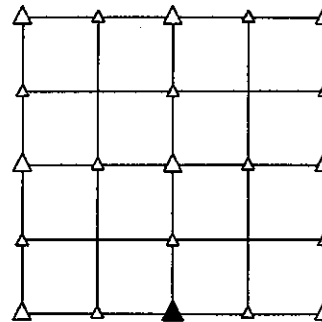

PLAN VIEW SHOWING RELATIVE LOCATION OF MONUMENT AND REFERENCE POINTS.

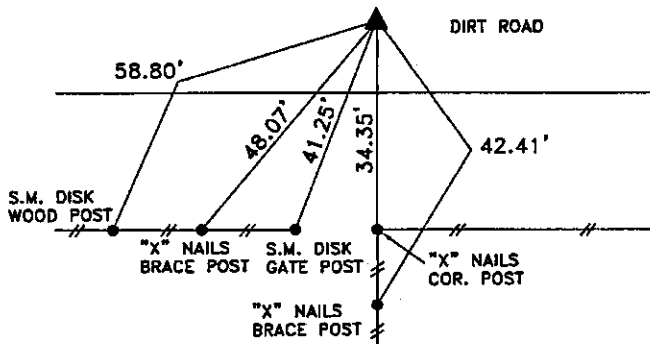

DISTANCES PLUMB CHAINED

S1/4 CORNER SECTION 23-85-39

I HEREBY CERTIFY THAT THIS LAND SURVEYING DOCUMENT WAS PREPARED AND THE RELATED SURVEY WORK WAS PERFORMED BY ME OR UNDER MY DIRECT PERSONAL SUPERVISION AND THAT I AM A DULY LICENSED LAND SURVEYOR UNDER THE LAWS OF THE STATE OF IOWA.

Terence E. Crawford
TERENCE E. CRAWFORD

IA LICENSE NO. 8893

AUG 12 2009

DATE

EXP. DATE DECEMBER 31, 2009

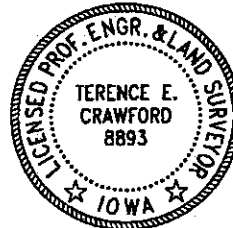

SE PROJECT NO. 22209
DRAWN BY: LLL