

Crawford County Recorder
Denise Meeves
Fee Book 2010-1774
08/26/2010 @01:45PM
PLC PLAT CORNER CER
Book: Page: # Pages: 1
Total Fees: \$0.00

INDEXED *DM*
FOLLOW UP *DM*
PROCESSED *DM*
RECORDED *DM*

PREPARED BY: MICKAEL F. BERNDT - CRAWFORD COUNTY ENGINEER'S OFFICE - COURTHOUSE - DENISON, IA. - 712-263-2449

UNITED STATES PUBLIC LAND SURVEY CORNER CERTIFICATE OF

LAND SURVEY MONUMENT SITUATED IN OTTER CREEK TOWNSHIP, THE WEST 1/4 CORNER
OF SECTION 34, T-85N, R-39W OF THE FIFTH P.M. CRAWFORD COUNTY, IOWA.

PREVIOUSLY RECORDED AS:

MONUMENT DESCRIPTION AND REMARKS

WEST 1/4 COR. OF SEC. 34-85-39

8/9/10 FOUND CM 4 FT. DEEP. SET 5/8" X 14" REBAR WITH YELLOW CAP #14808
6" DEEP OVER CM.

WEST 1/4 COR. OF SEC. 34-85-39

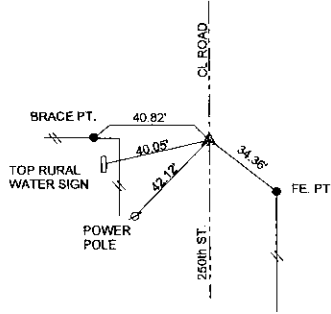

ALL DISTANCES ARE SLOPED CHAINED
ALL TIES ARE "X" NAILS UNLESS NOTED.

CORNER: WEST 1/4 COR.
SECTION: 34
TOWNSHIP: 85N
RANGE: 39W

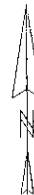
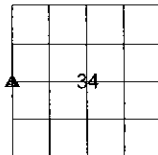

CERTIFICATION:

I HEREBY CERTIFY THAT THIS LAND SURVEYING DOCUMENT WAS PREPARED AND THE RELATED SURVEY WORK WAS PERFORMED BY ME OR UNDER MY DIRECT PERSONAL SUPERVISION AND THAT I AM A DULY LICENSED LAND SURVEYOR UNDER THE LAWS OF THE STATE OF IOWA.

Mickael F. Berndt
Signature

8/9/10
Date of Survey

MICKAEL F. BERNDT

14808

Dec. 31, 2010

Typed Name

L.S. No.

License Renewal Date

Pages covered by this seal 1

