

10-11 9-6-39- found 1 rock 4"x10"x17"
rotted remains of wood stake
at side of rock - 7' deep Lowered
and set C.M.

ties from x-spts in cor posts
29.2 E from cor post
30.7 W. " " " " "
49.3 NW. " " 30" Maple tree
40.9 NE " " 24" Willow tree

3
10 9-6-39- found 1 wood post
14" long, 2 pieces 8" x 6" long 8" deep
Lowered + set C.M.

ties from x-spts in cor posts
58.5 ESE from 8" Elm tree
26.7 S. " " cor post
35.4 N. " " " " "

12-19

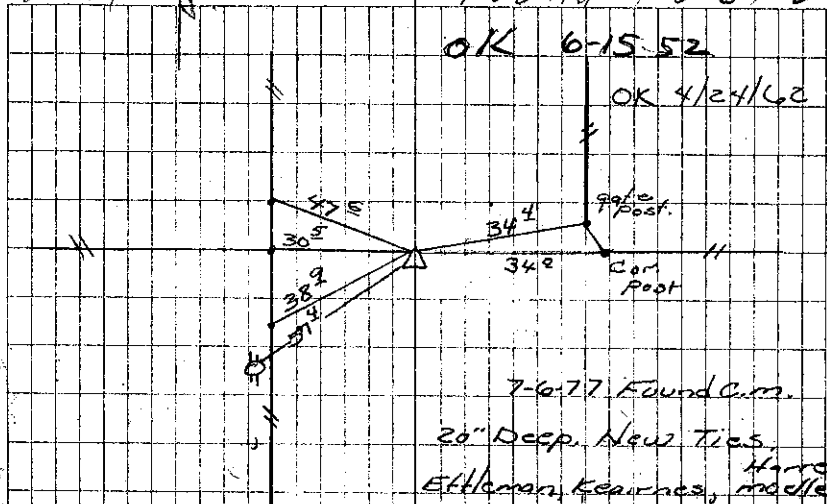

12-18

